

User's Manual

# DIGITAL PIANO

---

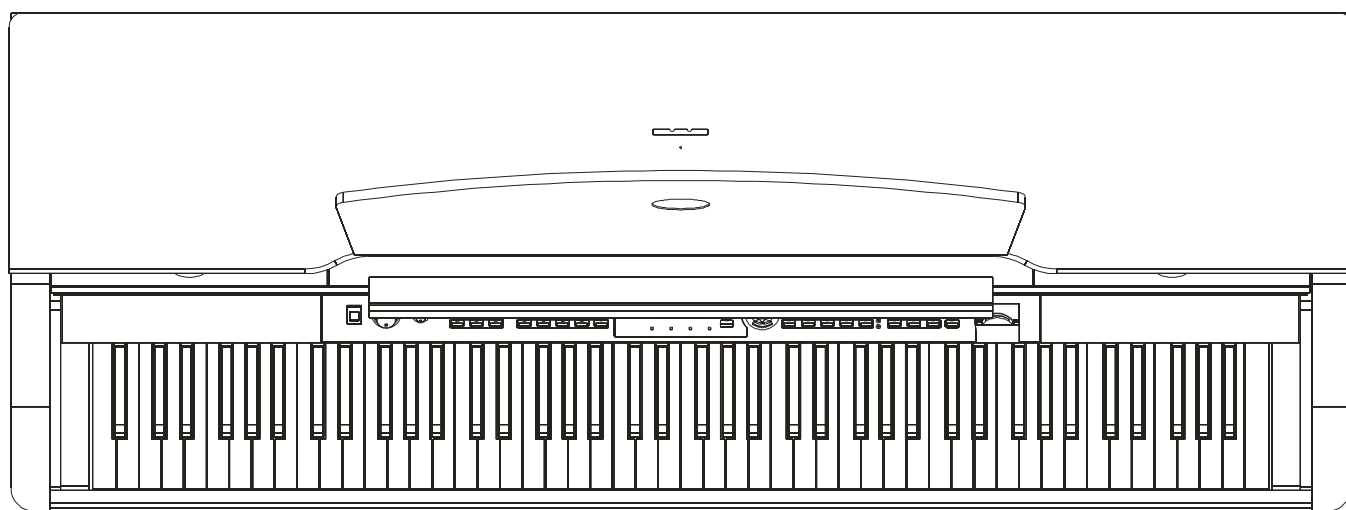



## Important Notes

**Your piano will give you years of playing pleasure if you follow the simple rules given below:**

### Location

- Do not expose the unit to the following conditions to avoid deformation, discoloration, or more serious damage.
  - Direct sunlight.
  - High temperature (near a heat source, or inside a car under long exposure of Sunlight.
  - Excessive humidity
  - Excessive dust
  - Strong vibration

### Power Supply

- Make sure to use the suitable AC adaptor, and the AC outlet voltage at your country matches the input voltage specified on the AC adaptor's label.
- Turn the power switch OFF when the instrument is not in use.
- An AC adaptor should be unplugged from the AC outlet if the instrument is not going to be used for an extended period of time.
- Unplug the AC adaptor during electric storms.
- Avoid plugging the AC adaptor into the same AC outlets as appliances with high power consumption, such as electric heaters or ovens. Also avoid using multi-plug adaptors since this could reduce sound's quality, causes operation errors and damages.

### Turn Power OFF When Making Connections

- To avoid damages, turn off the power switches before you connect the unit to the related devices or disconnect the related devices from the unit.

### Cleaning

- Clean the unit with a soft dry cloth.
- A slightly damp cloth may remove stubborn grime and dirt.
- Never use cleaners such as alcohol or thinner.
- Avoid placing vinyl object on top of the unit (vinyl might discolor and stick to the surface).

### Handling and Transporting

- Never apply excessive force to the controls, connectors or other parts of the instrument.
- Always unplug cables by gripping the plug firmly, but not pulling the cables.
- Disconnect all cables before moving the instrument.
- Physical shocks caused by dropping, bumping, or placing heavy objects on the instrument could result in scratches or even severe damages.

### Electrical Interference

- This instrument contains electric circuitry and may cause interference if it is placed too close to radio or television receivers. If this occurs, move the instrument further away from the receivers.

# Summarize

This piano is an easy to use digital piano. It has advanced functions especially in midi controller.  
This piano elaborated 20 beautiful voices, you can select them directly by using 10 Direct Select Button.  
This piano provide with SD card function, you can choose your favorite MIDI song to play;  
You can also backup your recording setting to SD card.  
This piano still has the MIDI port to help the user to create their own music.

You are recommended to study this manual carefully before using the unit.

## Main Features

### Keyboard:

88 touch keyboard with 3 touch levels.

### Operation:

Use the **[+/YES]** & the **[-/NO]** button or direct select button to select desired function & parameters.

### Voice:

20 voices in total with 10 select buttons.

### Voice demo :

It helps you to get an idea of what the voice selected is capable of doing.

### Style:

20 piano styles in total, use the **[+/YES]** & the **[-/NO]** button to select.

### Song:

60 songs in total, each one has self-learning mode.

### Song learning:

Use the **[TRACK1/SONG MELODY OFF]** button to enter.

### Record:

1 user song, include 2 track tracks.

### SD card:

Play midi files, save recorded data.

### Style control buttons:

START/STOP, ACC VOL, FILL A/FILL B.

### Others function buttons:

DUAL, SPLIT, REVERB/CHORUS, METRO, TRANSPOSE +/-, TOUCH, etc.

### Buttons with indicator:

FILL A/FILL B, RECORD, PLAY/STOP, ACC VOL, SPLIT, DUAL, REVERB/CHORUS, TOUCH, METRO, (SD)STORE, (SD)PLAY/STOP, TRACK 1/SONG MELODY OFF, TRACK2, SCALE.

### Pedal:

Sustain pedal, soft pedal, sostenuto pedal.

### Interface:

MIDI IN/OUT, USB, HEADPHONE, AUX.OUT

### NOTE:

- Pressing **[+]** and **[-]** buttons together when turning on the piano, will put all values back to default setting.

# Conent

<b>Set-up Guide</b> .....	<b>5-7</b>
<b>General Guide</b> .....	<b>8-9</b>
<b>The Connectors</b> .....	<b>10-11</b>
- Using the AC power jack.....	10
- Using Headphones .....	10
- Using the AUX.OUT jack.....	10
- Using the Foot Pedals .....	11
- Using the MIDI IN/OUT jack .....	11
- Using the USB jack .....	11
<b>Operation</b> .....	<b>12-22</b>
- Power on & Master Volume.....	12
- Song .....	12-13
- Voices and Effects .....	13-17
- Metronome.....	18
- Style Control .....	18-19
- Record.....	20-21
- Lesson.....	21
- SD Function.....	21-22
<b>MIDI</b> .....	<b>23</b>
- What is MIDI.....	23
- MIDI Connection Method.....	23
- Major Application .....	23
<b>Specifications</b> .....	<b>24</b>
<b>Voice List</b> .....	<b>25</b>
<b>Style List</b> .....	<b>25</b>
<b>Song List</b> .....	<b>26</b>
<b>MIDI Implementation Chart</b> .....	<b>27.</b>

# Set-up Guide

1. Open the package, and check whether the following parts are available:

- 1. Piano body
- 2. Music stand
- 3. Left leg component
- 4. Left front leg
- 5. Right leg component
- 6. Right front leg
- 7. Foot pedal unit
- 8. Back panel skirt

- 9. Left metal strip
- 10. Right metal strip
- 11. Hand screws (4pcs)
- 12. Screws 6x45 (2pcs)
- 13. Screws 6x18 (6pcs)
- 14. Screws 6x35 (4pcs)
- 15. Screws 6x12 (2pcs)
- 16. Screws 4x15 (4pcs)
- 17. Power cable stabilizing hook (2pcs)

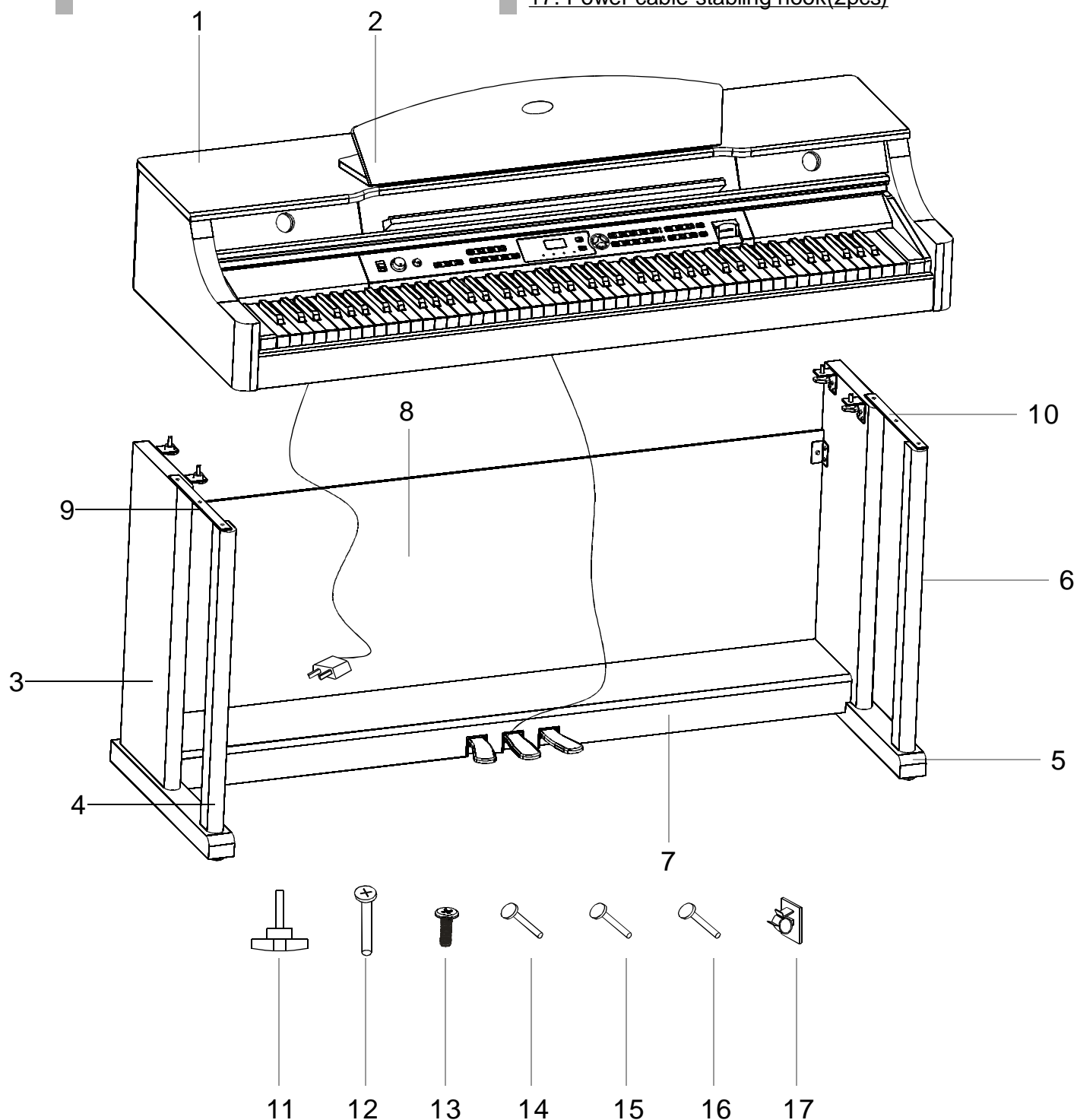

2. Follow the illustration below and finish off the set-up procedures.

A. Please use the screws ( $\varnothing 6 \times 45$ ) fixed the front legs to correspond legs components, as follow guide:

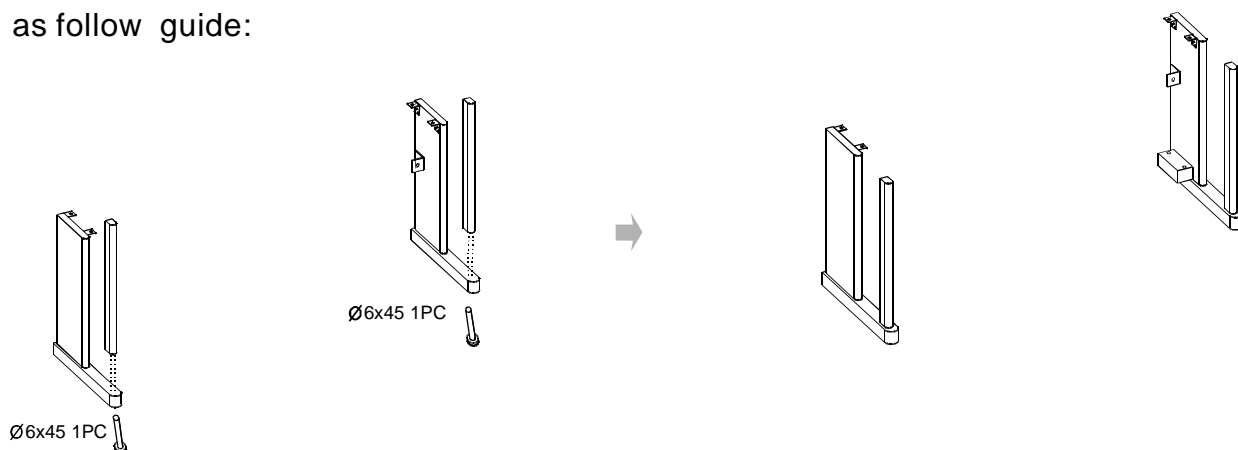

B. Please use the screws ( $\varnothing 6 \times 18$ ) fixed the metal strips to correspond legs components, as follow guide:

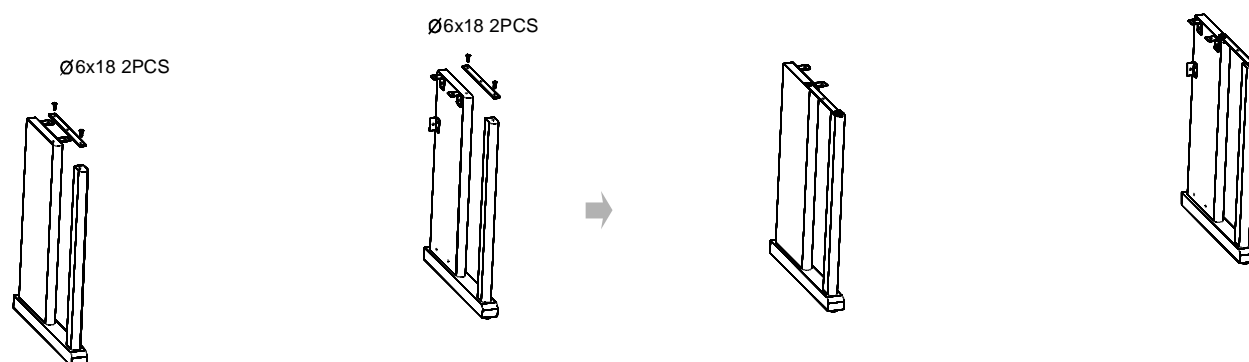

C. Put the foot pedal unit in between the left and right legs components, use 4 pieces of screws ( $\varnothing 6 \times 35$ , 2PCS on each side) to stable the legs onto the foot pedal unit.

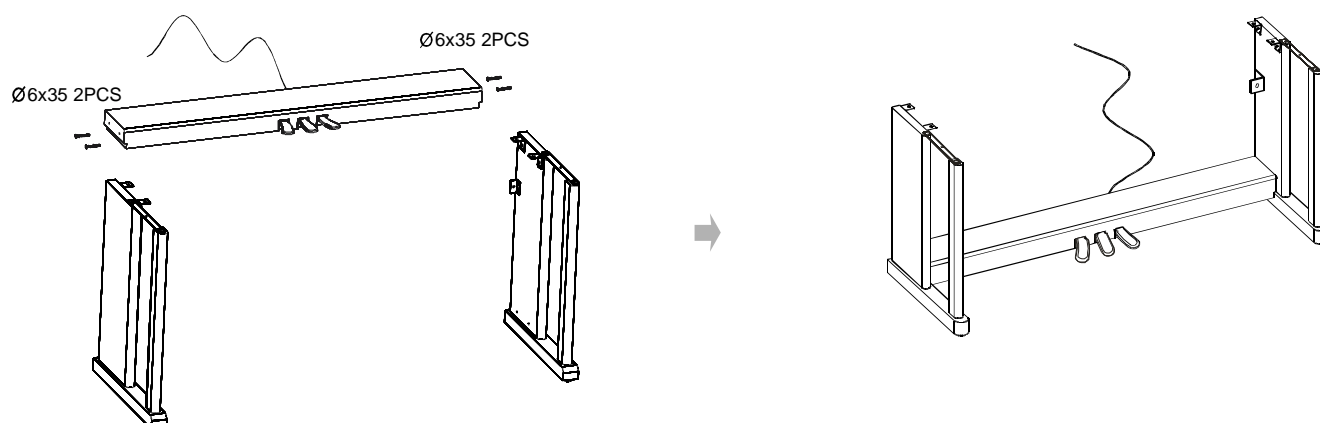

D. Use 2 pieces the screws( $\varnothing 6 \times 12$ ) and 4 pieces the screws ( $\varnothing 4 \times 15$ ) to stable the back panel skirt onto the assembly finished in PART C.

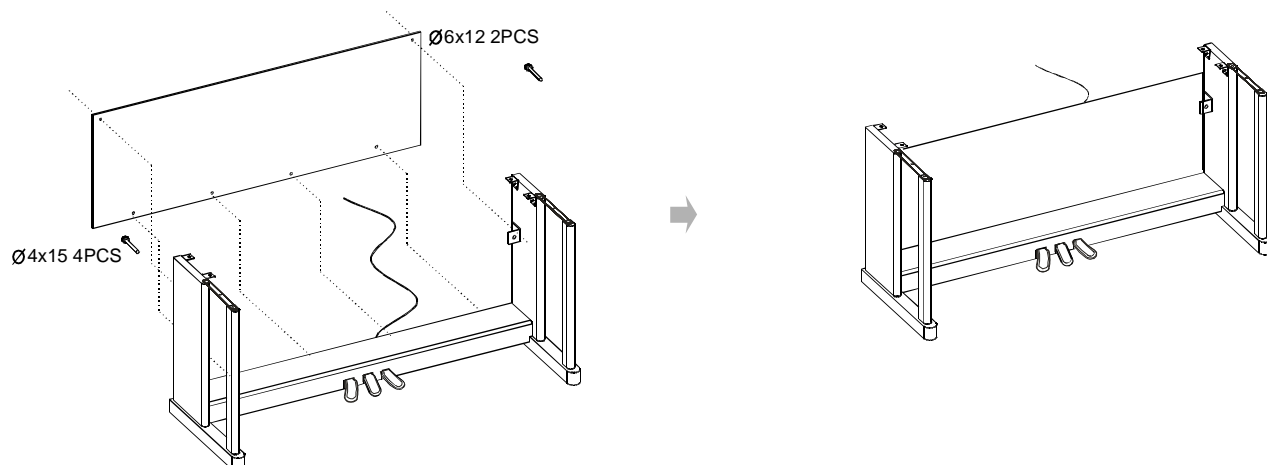

E. Put the piano body on the top of the finished assembly in part D. Use 4 pieces of hand screws and 2 pieces the screws ( $\varnothing 6 \times 18$ ) to stable afterward.

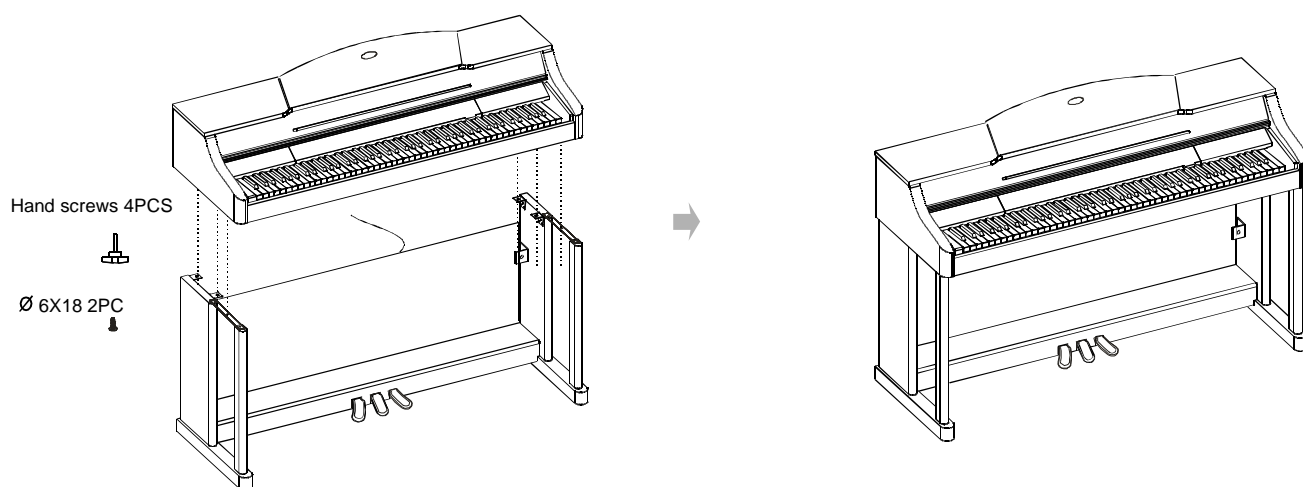

F. After the initial set-up, connect pedal cable in the foot pedal unit to the rear-panel PEDAL jack, and stick the cable stabling hook on the internal side of the leg component to fix the pedal cable. (See the below illustration for reference).

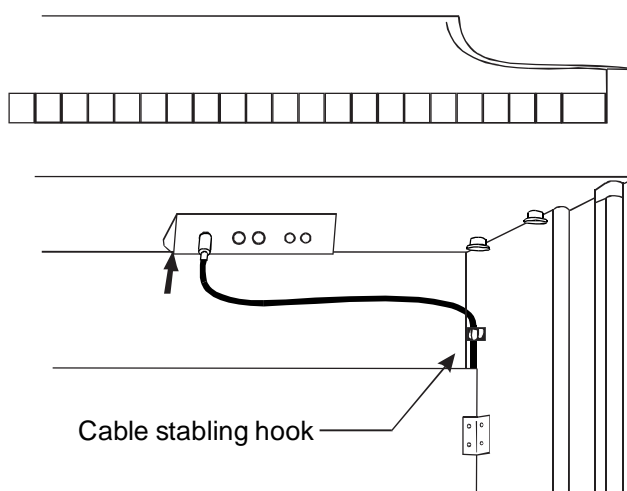

# General Guide

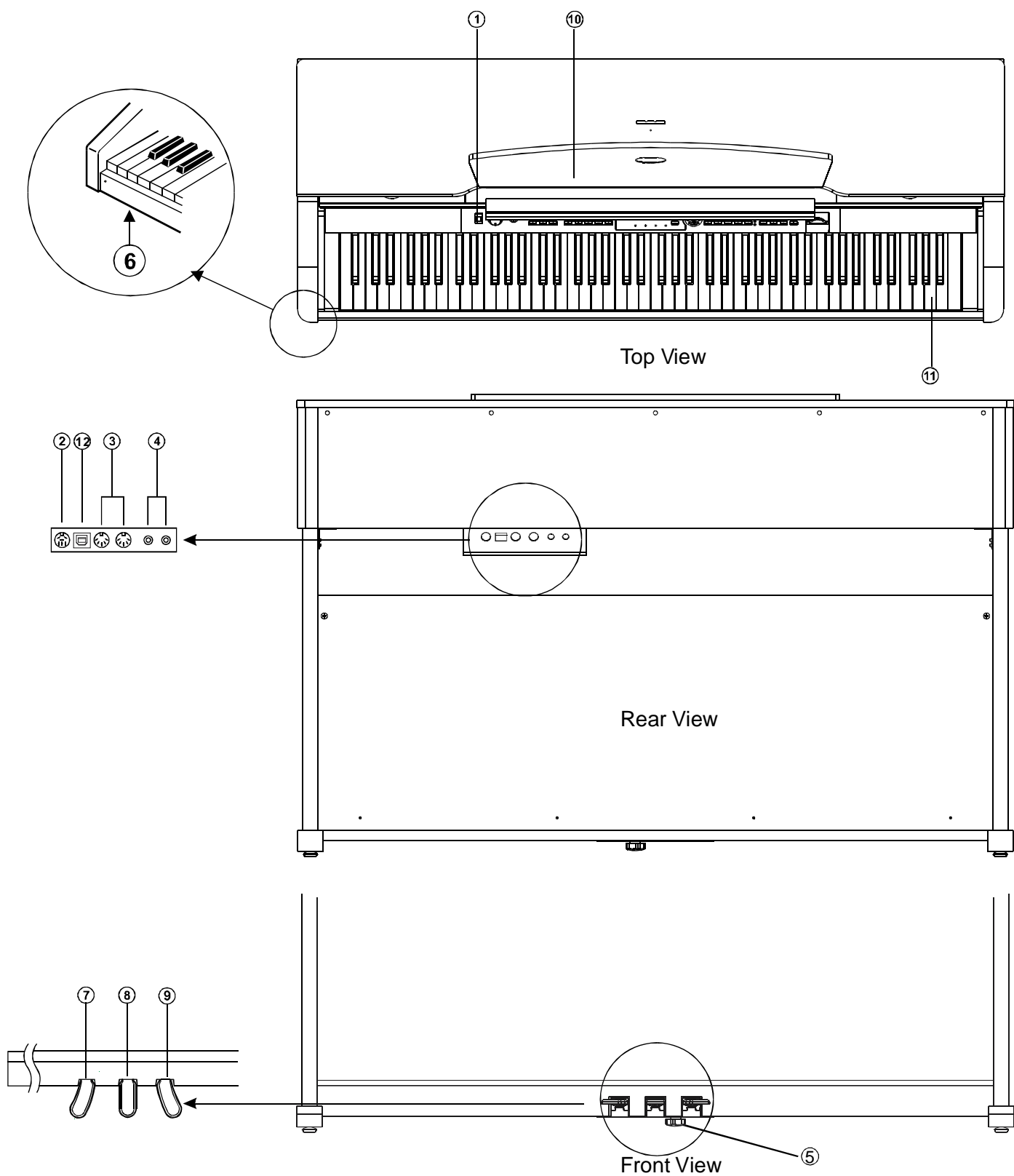

- ① Control Panel
- ② Pedal Jack
- ③ MIDI IN/OUT Jack
- ④ AUX. OUT Jack
- ⑤ Special Pedal Clog
- ⑥ Headphones Jack

- ⑦ Soft Pedal
- ⑧ Sostenuto Pedal
- ⑨ Sustain Pedal
- ⑩ Music Stand
- ⑪ Piano Keyboard
- ⑫ USB Jack



## Control Panel

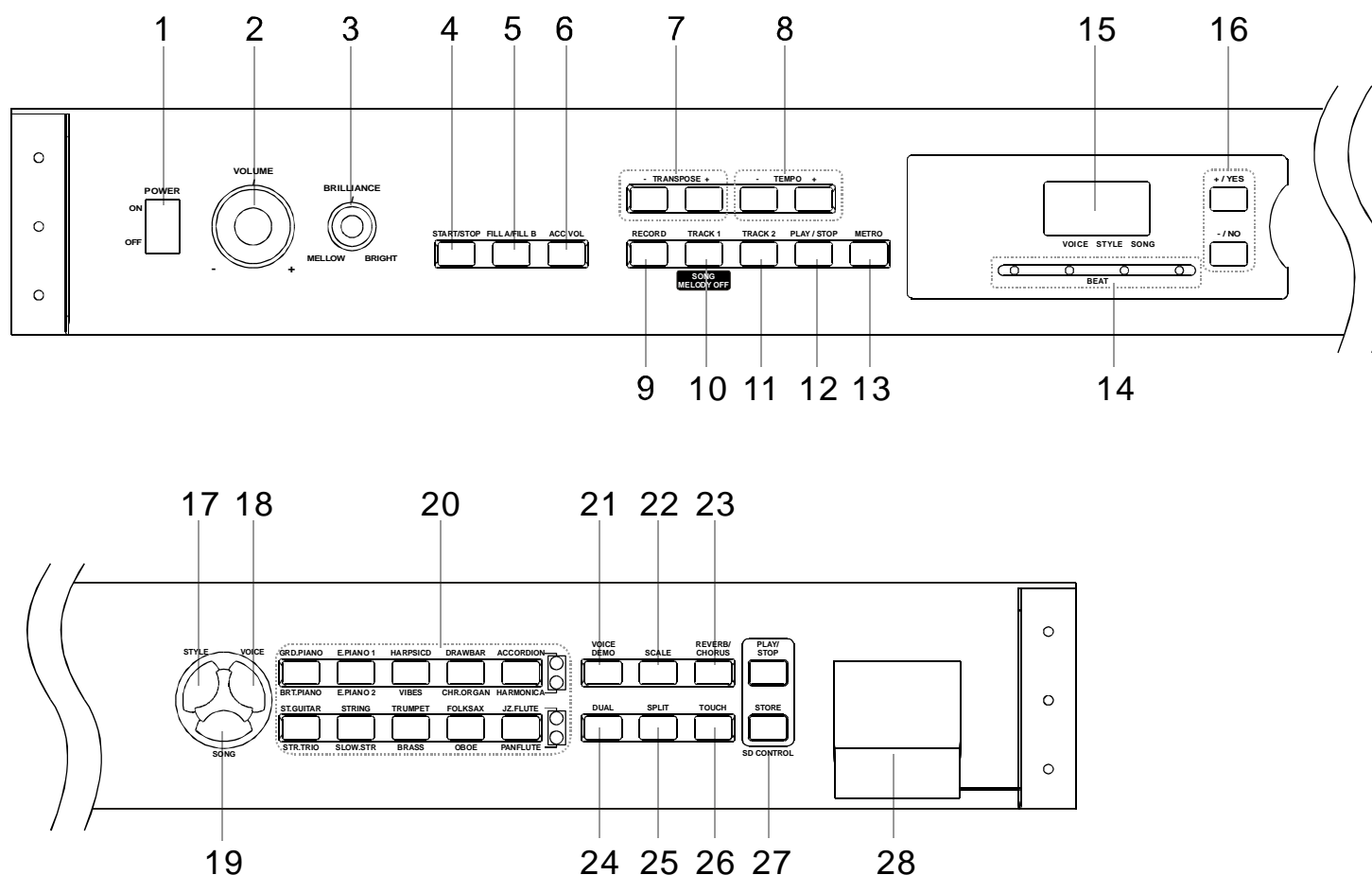

- |                 |                               |
|-----------------|-------------------------------|
| ① POWER SWITCH  | ⑩ TRACK 1/SONG MELODY OFF     |
| ② MASTER VOLUME | ⑪ TRACK 2                     |
| ③ BRILLIANCE    | ⑫ PLAY/STOP                   |
| ④ START/STOP    | ⑬ METRO                       |
| ⑤ FILL A/FILL B | ⑭ BEAT LED INDICATOR          |
| ⑥ ACC. VOL      | ⑮ LED DISPLAY                 |
| ⑦ TRANSPOSE +/- | - VOICE                       |
| ⑧ TEMPO +/-     | - STYLE                       |
| ⑨ RECORD        | - SONG                        |
|                 | ⑯ +/YES & -/NO                |
|                 | ⑰ STYLE                       |
|                 | ⑱ SONG                        |
|                 | ⑲ SONG                        |
|                 | ⑳ VOICE DIRECT SELECT BUTTONS |
|                 | ㉑ VOICE DEMO                  |
|                 | ㉒ SCALE                       |
|                 | ㉓ REVERB/CHORUS               |
|                 | ㉔ DUAL                        |
|                 | ㉕ SPLIT                       |
|                 | ㉖ TOUCH                       |
|                 | ㉗ SD CONTROL                  |
|                 | - PLAY/STOP                   |
|                 | - STORE                       |
|                 | ㉘ SD SLOT                     |

# The Connectors

## Using the AC power jack

- 1、Ensure the piano is turned off when connecting and disconnecting the power.

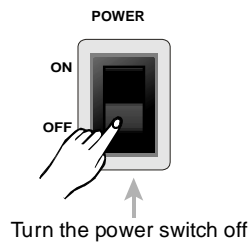

- 2、Turn the volume switch anti-clockwise to reach the minimum volume level.

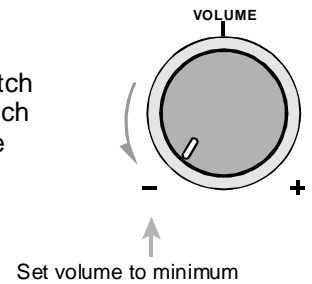

- 3、Plug the power cord into an AC power outlet.

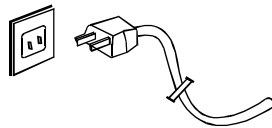

- 4、If you have done the above procedures you are now safe to turn on the piano.

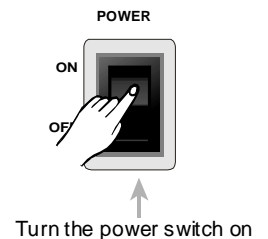

### NOTE:

- When the piano is not in use or in the time of thunder-storm, please disconnect the power for safety sake.

## Using headphones jacks

There are two headphones jacks on the left underneath the piano body.

- 1、When an optional set of stereo headphones is connected with the headphones jack 2, the sound from speakers will switch off automatically resulting in only the sound from headphone to be heard.
- 2、When jack 1 is connected with the stereo headphones, the sound can be heard from both headphones and speakers of the piano.
- 3、Connect two pairs of headphones to jack1 and jack2, it helps the user play with the teacher or friend in a quiet surrounding.

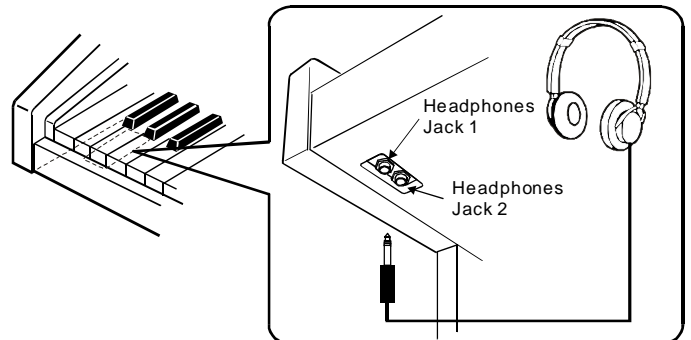

- Never use the headphone with high volume, as it may hurt your sense of hearing.
- To prevent the damage of the speakers, ensure that the volume is set to the minimum level before connecting the power and other devices.

## Using the AUX.OUT jacks

Connect the rear-panel AUX.OUT jack to amplified speakers, amplifiers or domestic hi-fi-units for external amplification.

### NOTE:

- Connect both left(L) and right(R) channels for the stereo effect.
- If you only connect either one of the channels, the connected channel will only take effect.

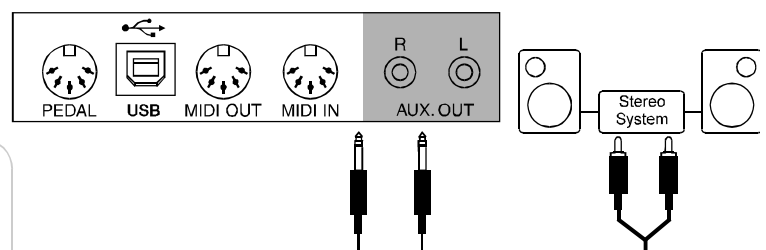

## Using the Foot Pedals

Connect the plug of the foot pedal unit to the pedal jack on the rear panel.  
You will experience the sustain/soft/sostenuto effect.

### NOTE:

- Step on the sustain pedal ,all notes played on the keyboard have a longer sustain.
- Step on the sostenuto pedal, the notes played before you step on have a sustain effect.
- Step on the soft pedal , all notes played on the keyboard have a soft effect.

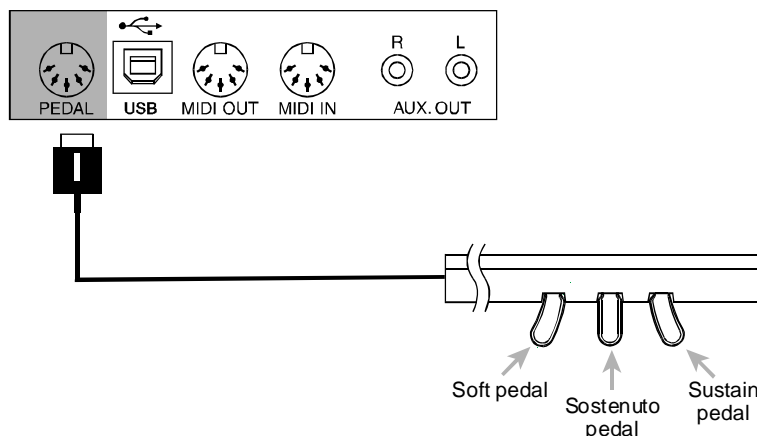

## Using the MIDI IN/OUT Jack

MIDI stand for Musical Instrument Digital Interface. MIDI is a world wide standard that makes it possible for various electronic musical instruments and other devices.

### 1、MIDI IN:

Data transmitted from other MIDI instrument via MIDI is received at this terminal.



### 2、MIDI OUT:

Data produced by the Digital Piano is transmitted to other MIDI instruments via MIDI from this terminal.

## Using the USB Jack

### 1、Connect PC or other USB host devices that support USB audio.

- 2、For devices with USB cable, you can simply connect the MIDI/USB converter to your USB connector on the devices and plug the MIDI in or MIDI out cables into the piano, after the driver is installed and initialization is finished, you can choose USB Audio Device in the device menu of the software to transfer midi data.

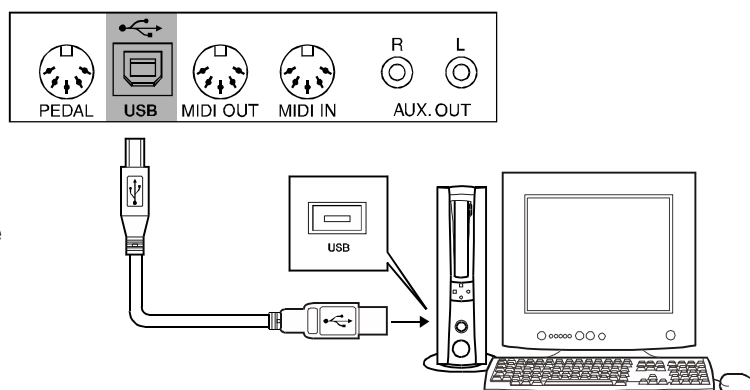

# Operation

## Power on & Master Volume

- 1、Turn the **[POWER]** switch to on. The LED display lightens up.

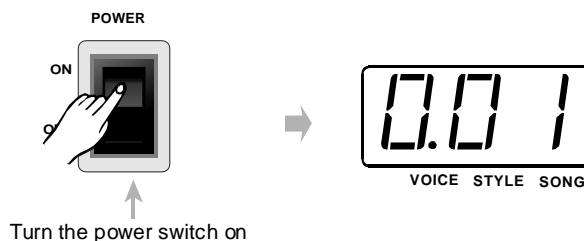

- 2、Rotate the volume control knob to adjust the volume to your desired level.

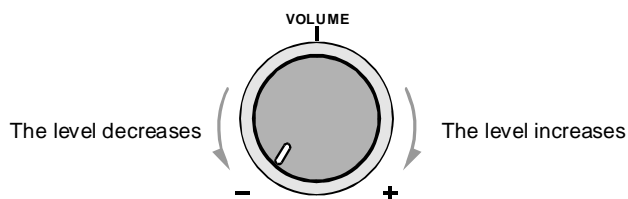

- 3、Press the **[+/YES]** and the **[-/NO]** button synchronously, and then power on the piano, it can reset all the setting to the default value and erase the record data.

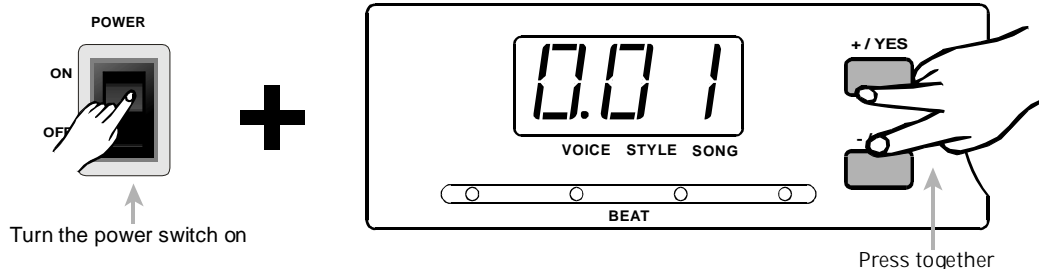

### NOTE:

- If the LED display has not lightened up after you power on the piano, please check the power supply.
- If the piano is silent, the volume may be adjusted to its minimum level.
- Although Mains switch is in OFF position, the piano is not disconnected from the power supply completely!

## Song

There are 60 songs in total. (See Appendix 3 ).

- 1、 **PLAY a song:**  
Press the **[SONG]** button to enter the song mode, the **SONG** flag on LED is lightened. It will play all songs repeatedly in a cycle.

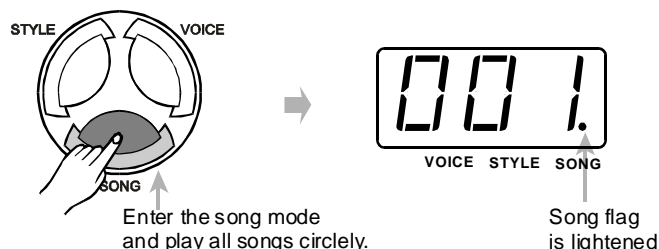

Press the **[START/STOP]** button to stop playing the song, but it will not quit the song mode. The 2nd time you start playing the song by pressing the **[START/STOP]** button, it will play current song repeatedly.

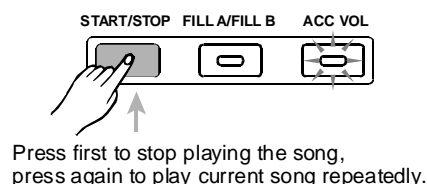

## 2. SELECT a song:

Use the **[+/YES]** or **[-/NO]** button to select the song you want. If you select the new song, LED will display its number at first and then display introductory beat and the measure count.



The beat LED indicators are lightened in turn.

Select a song

## 3. INTRODUCTORY BEAT:

After pressing **[START/STOP]**, the measure count begins from negative value to 1, and then begins to play the song.

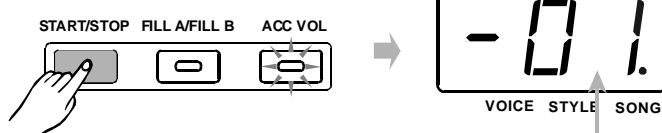

Display the measure count

4. Press the **[TRACK1/SONG MELODY OFF]** button to enter self-learning mode, and turn on/off the main melody of the song.

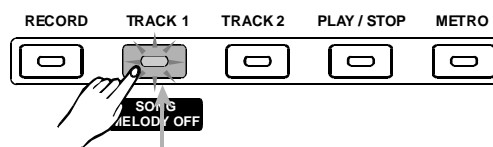

The LED indicator is lightened.

5. While the song stop playing, you can press the **[VOICE]**, **[STYLE]**, **[DUAL]** or **[SPLIT]** button to exit.

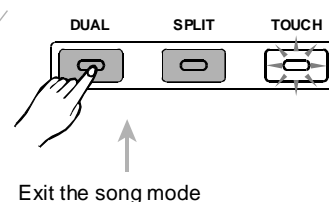
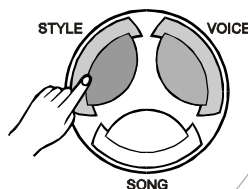

Exit the song mode

## Voices and Effects

There are 20 voices in total (See Appendix 1).

### Voice Select

- When power is on, LED lightens the **VOICE** flag and displays the 001 voice number.
- Press the **[VOICE]** button to enter the voice mode, LED displays the **VOICE R1** number.
- Press the **[DUAL]** button to enter the dual voice mode, LED displays the **VOICE R2** number.
- you can select other voice by pressing the **[+/YES]** and the **[-/NO]** or voice Direct Select buttons.

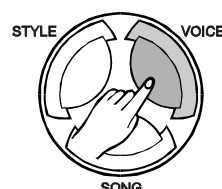

Display VOICE R1

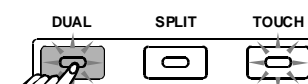

Display VOICE R2

### Use Direct Select buttons to select

There are 10 voices Direct Select buttons to select 20 voices. Each Direct Select button can be used to choose 2 different voices.

Press the first time to select upper layer voice, press the second time to select the lower layer voice.

When you select the upper layer voice, the upper layer indicator turns on;

when you select the lower layer voice, the lower layer indicator turns on and the upper layer indicator turns off.

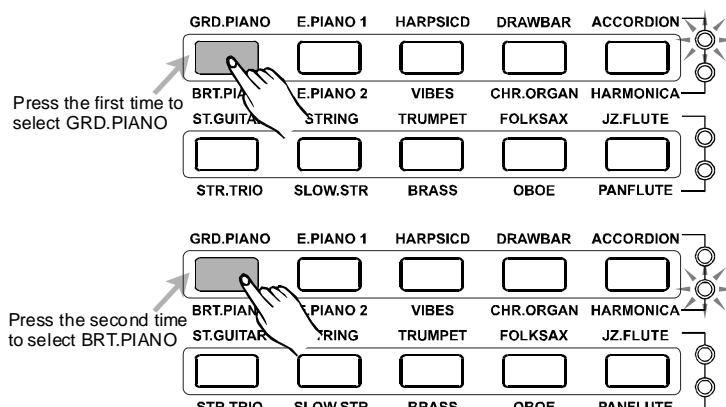

Press the first time to select GRD.PIANO

Press the second time to select BRT.PIANO

## VOICE DEMO

1、 Each demo song demonstrate one voice which is selected.

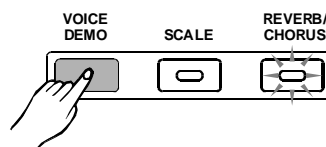

2、 In the voice/style status:

- In **VOICE R1** mode, press **[VOICE DEMO]** button to play the demo song which is programmed with the current R1 voice.
- In **DUAL** mode, press **[VOICE DEMO]** button to play the demo song which is programmed with the current R2 voice.

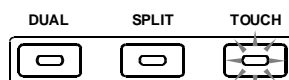

Turn off the button to play VOICE R1 demo

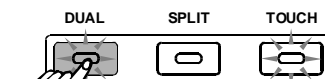

Turn on the button to play VOICE R2 demo

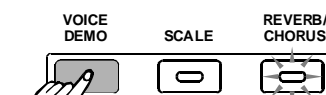

Press it again to exit the demo.

4、 If you change the voice , and it will exit the demo mode.

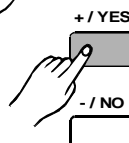

Change a voice and exit the demo.

## DUAL

The piano has dual voice. You can create the new sound through this function for richer and punchier sounds. You can get two different sounds at the same time when pressing one key in the right area in the keyboard.

Press the **[DUAL]** button to turn on the DUAL mode, the **VOICE** flag on the LED and the indicator are both lightened. The dual voice number is also displayed on the LED.

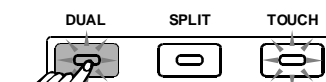

Turn on the DUAL voice



Voice flag is lightened

Then, you can get two different sounds at the same time when you press one key on the keyboard.

2、

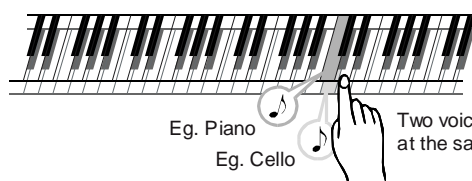

Two voices will sound at the same time.

Use the **[+ / YES]** / **[- / NO]** button and voice Direct Select buttons to select your desired voice. The default voice number is 007.

3、



Select a dual voice

Press the **[DUAL]** button again to turn off the DUAL mode, the indicator goes off.

4、

### NOTE:

While the keyboard is in split mode, only the right hand area can respond the dual voice, the left hand below split point would respond.

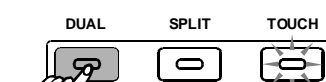

The indicator goes off.

## SPLIT POINT

You can split the keyboard to melody and chord area by this function.

- 1、 Press the **[SPLIT]** button, LED displays the current split parameter XXX .
- 2、 Use the **[+/YES]** / **[-/NO]** button or keyboard to change it, after exit the setting mode the new value becomes to the new split point, the split default value is 34.
- 3、 The new split point belongs to the left area of the keyboard.

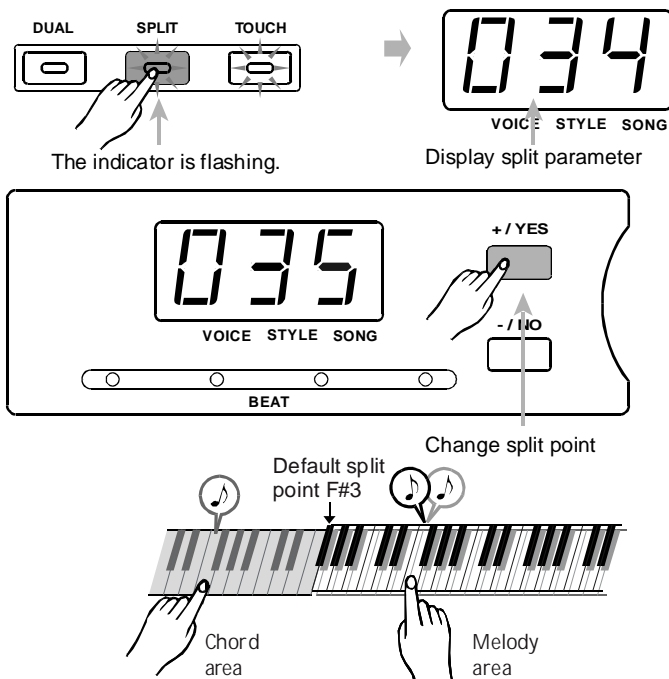

## TOUCH

This function allows you to turn on the dynamic level when playing the keyboard.

- 1、 When power is on , the TOUCH indicator lightened. Press the **[TOUCH]** button continuously to select the touch response type, the TOUCH indicator flashes and displays touch response type 00X temporarily on LED.
- 2、 There are 4 touch response types. Press **[TOUCH]** button repeatedly to select, the default is 002.
- 3、 If the type is set as **OFF**, it means no touch response to keyboard, the TOUCH indicator goes off.

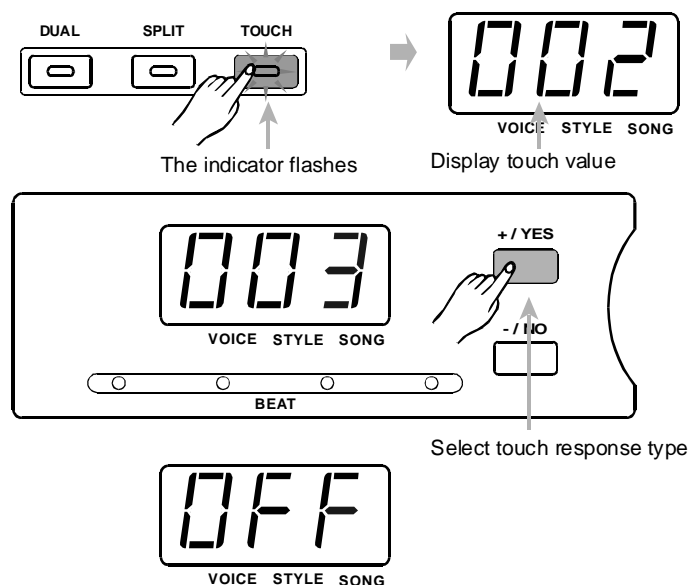

### NOTE:

If you don't press any button for 2 seconds in touch response type select mode, it will quit this mode automatically.

## BRILLIANCE

This function allows you to change the tonality of the sound.

When the piano is power on, rotate BRILLIANCE knob clockwise, it sounds brighter ; rotate BRILLIANCE knob anti-clockwise, it sounds more gloomy.

You can change the piano brilliance as your wish.

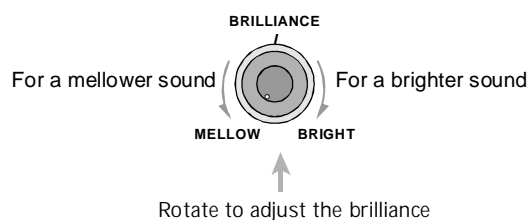

### NOTE:

The volume level will be increased/decreased slightly when rotating the **[BRILLIANCE]** to the BRIGHT/MELLOW.

## REVERB/CHORUS

**REVERB/CHORUS effect will make the keyboard sound much more fully and widely.**

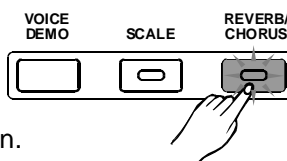

r 08  
VOICE STYLE SONG

c 00  
VOICE STYLE SONG

1、When power is on, the REVERB/CHORUS indicator is on.

2、Press the **[REVERB/CHORUS]** button to switch the DSP response setting.

3、Press **[REVERB/CHORUS]** repeatedly to switch to reverb or chorus setting mode.

4、There are 32 level to be selected by pressing **[+/YES]** and **[-/NO]** button. The default chorus level is 00, the default reverb level is 08.

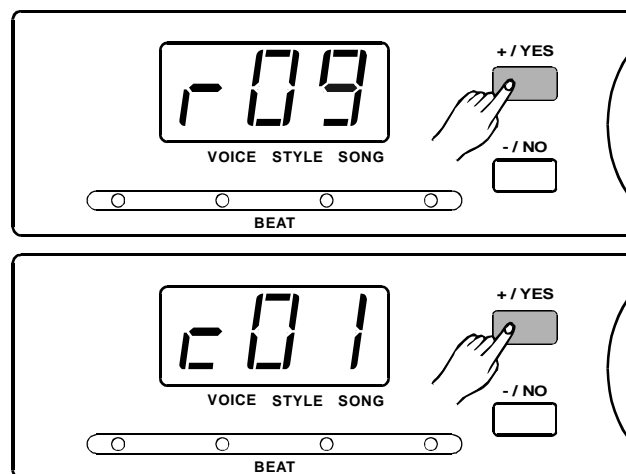

## TRANSCOPE

1、You can change the pitch of the entire keyboard by semitone steps with TRANSCOPE function.

2、Press the **[TRANSCOPE +]** or **[TRANSCOPE -]** button for the first time, LED displays current transpose value temporarily.

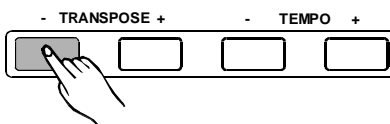

008  
VOICE STYLE SONG

Display current transpose value

3、Press **[TRANSCOPE +]** to increase the value and Press **[TRANSCOPE -]** to decrease the value, the maximal range to be adjusted is from -012 to +012 semitones, the default value is 000.

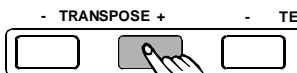

increase the value

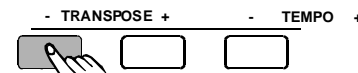

Decrease the value

4、In TRANSCOPE setting , press the **[TRANSCOPE +]** and **[TRANSCOPE -]** button simultaneously to set the value to default.

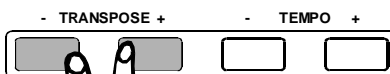

000  
VOICE STYLE SONG

Display default transpose value

**NOTE:**

*If you don't press any button for 2 seconds in transpose setting mode, it will quit this mode automatically.*



## SCALE

This function allows you to experience different scales when you play certain genres of music that is not composed based on twelve equal interval.

- 1、Press **[SCALE]** button to enter into scale mode and the button indicator lights up; The default scale is 001 Pythagor.

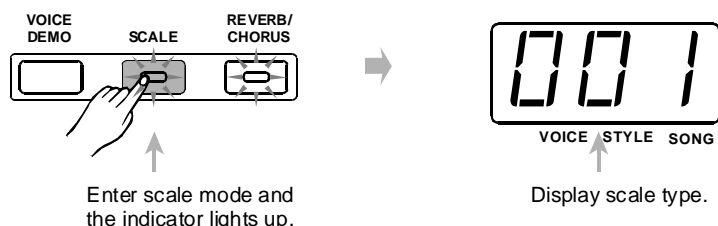

- 2、There are 6 types of scale to select: Pythagor, Major, Minor, Meantone, Werckmei, Kirnberg.

Types of scale :

Number	Name	Number	Name
1	Pythagor	4	MeanTone
2	Major	5	Werckmei
3	Minor	6	Kirnberg

- 3、Press **[SCALE]** button again to exit scale mode and the button indicator goes off.

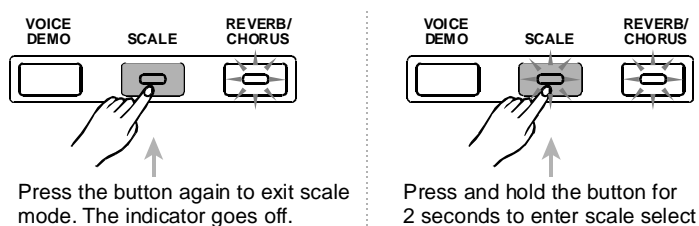

- 4、Hold and press **[SCALE]** for 2 seconds to enter into SCALE select status. The scale now flashes and the scale number displayed on LED.

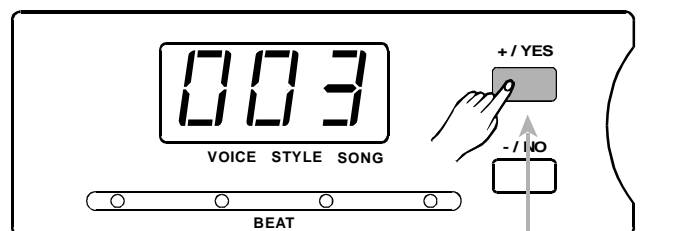

- 5、Use **[+ / YES]** or **[- / NO]** to select the scale type, play the key from C7~B7 to select scale root.

- For example, to select the scale named "Minor" and set the root key to "G", keep pressing **[+ / YES]** till "003" displayed temporarily on the LED, then press the G7 key to set the root, LED displays "G", "G" stands for "Scale Root".

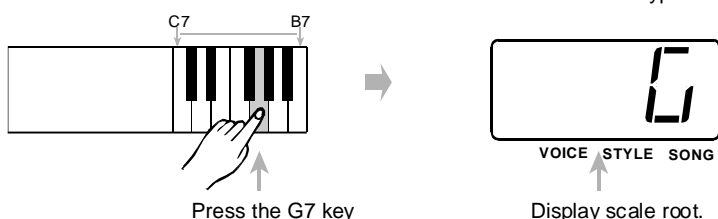

## PEDAL

### 1、SUSTAIN Pedal

When you step on the sustain pedal, all notes played on the keyboard have a lingering effect.

### 2、SOSTENUTO Pedal

When you step on the pedal, the first note you play has a sustain effect, but all subsequent notes will not sustain.

### 3、SOFT Pedal

when you step on the soft pedal, all notes played on the keyboard have a soft effect. The volume is reduced slightly

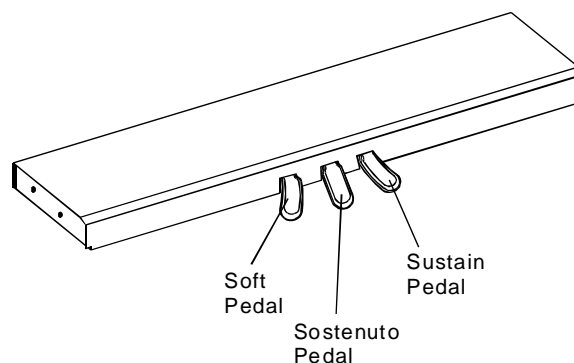

## Metronome

1. Press the **[METRO]** button to turn on the metronome and the metronome sound will be played.
2. Press the button again to turn off the metronome.
3. When the style stops to play, the beat type follows 4/4 after turning on the metronome.  
When the style begins to play, the beat type follows the current style.
4. Metronome can be turned on together with the style.  
If the style plays at first, then to turn on the metronome, the metronome will respond next measure.  
If the metronome plays at first, then to start to play the style, the metronome responds at once to the first beat of the style.

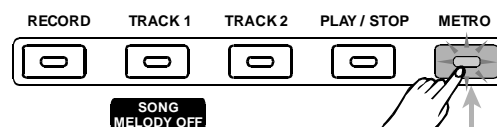

The LED indicator is lightened.

Metronome can be turned on together with the style.



The beat LED indicators are lightened in turn.

## Style Control

There are 20 styles in total. (See APPENDIX 2).

### STYLE SELECT

1. Press the **[STYLE]** button to enter style mode, the style number and style flag on the LED are both lightened.
2. You can use the **[+/YES]** / **[-/NO]** button to select the style you want.

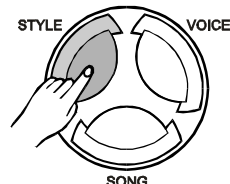

Style flag Style number



Select the style

### START/STOP THE STYLE

1. When the style is not playing, you can press the **[START/STOP]** button to enter "SYNC START" mode, the beat point are flashing at the same time, now the style will be start with A.B.C. on if you press the key in the chord area on keyboard.
2. Press the **[START/STOP]** button again to stop style play and turn off the A.B.C. function at the same time.

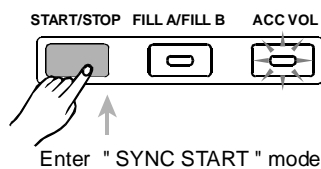

Enter "SYNC START" mode

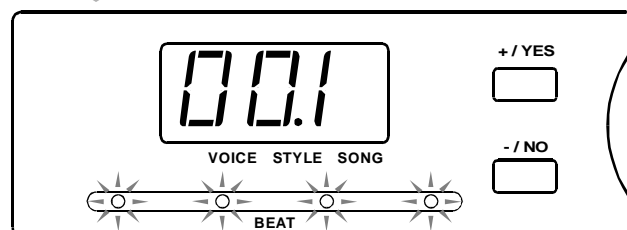
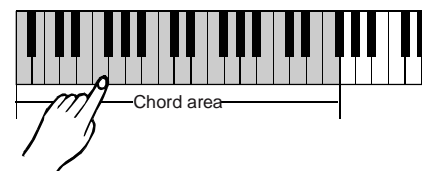

The beat LED indicators are flashing at the same time.

## FILL IN A/B

1. In **NORMAL** mode, press the **[FILL A/FILL B]** button to insert 1 measure fill and the **FILL A/FILL B** indicator is flashing, after one measure is over, the style enters variation mode.
2. In **VARIATION** mode, press the **[FILL A/FILL B]** button to insert 1 measure fill and the **FILL A/FILL B** indicator is flashing, after one measure is over, **NORMAL** style will be returned.
3. When power is on, the preset style mode is **NORMAL** mode.

Style is not playing:

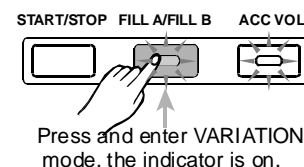
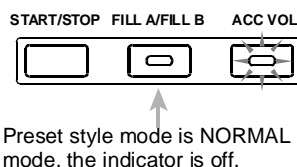

Style is playing:

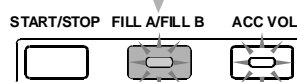
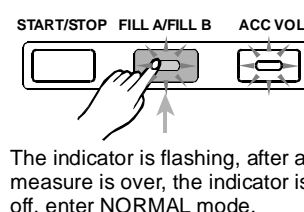
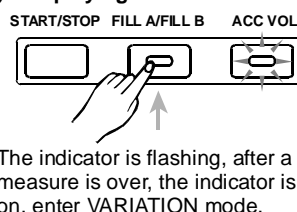

## ACCOMP VOLUME

1. Press the **[ACC VOL]** button, LED displays the current volume temporarily.
2. You can use the **[+/YES]** / **[-/NO]** button to adjust the volume from 0 ~ 31. (Default Accomp Value is 24) The **ACC VOL** indicator is flashing at the same time.
3. When power is on, the **ACC VOL** indicator is on.
4. In **ACC VOL** mode, press the **[+/YES]** and **[-/NO]** buttons synchronously can mute the accompaniment, the **ACC VOL** indicator goes off at the same time; If you press the **[+/YES]** and **[-/NO]** buttons again synchronously can open the accompaniment, the **ACC VOL** indicator is lightened at the same time.

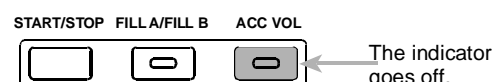
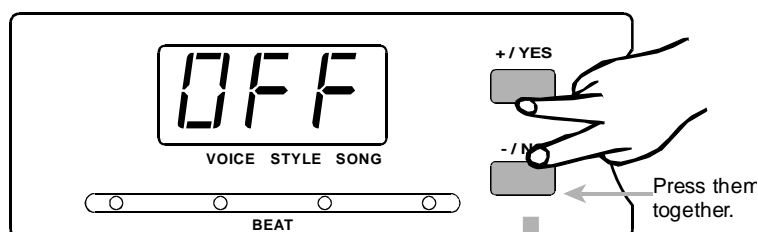
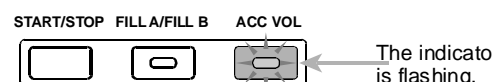
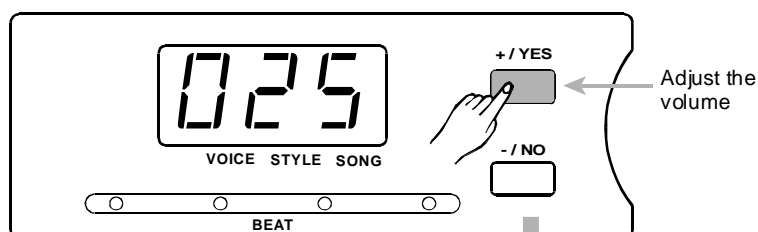

## TEMPO

1. Use the **[TEMPO+]** or **[TEMPO-]** button to adjust the tempo from 30 to 280.
2. Press the **[TEMPO+]** and **[TEMPO-]** synchronously to set to the default tempo.
3. When the style is not playing, it will take out the default tempo of the style if you select the style. When the style is playing, it will keep the current tempo once you change the style.

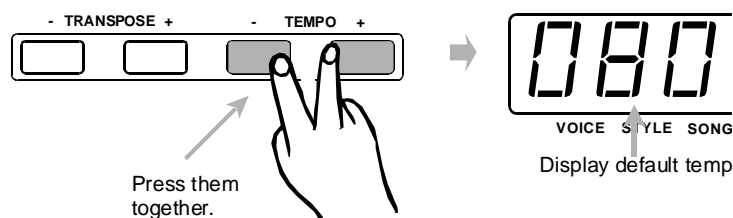
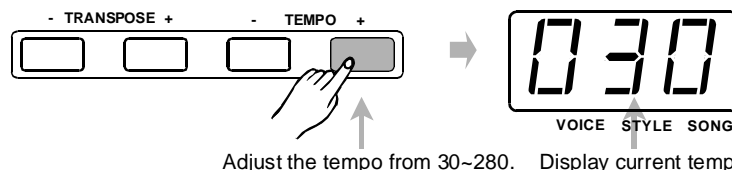

## Record

There is one user song can be recorded, include 2 Melody Tracks.

### RECORD SONG

#### 1、Waiting for recording:

Press the **[RECORD]** button for the first time to enter the record mode.

- The RECORD indicator flashes, four beats flashes synchronously to indicate waiting for recording.
- At the same time an empty track will be selected to be recorded automatically and relative track flag flashes (the selection order is Track1,Track2, the Track1 will be selected while neither the tracks is empty )
- You also can press the **[TRACK 1/SONG MELODY OFF]** or **[TRACK 2]** button to select the track you want to record.

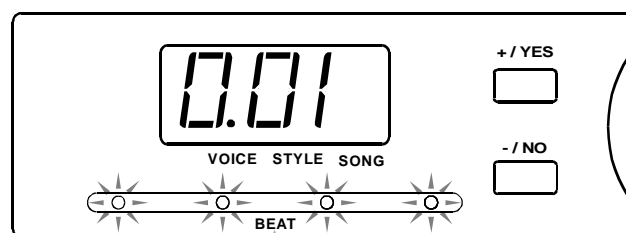
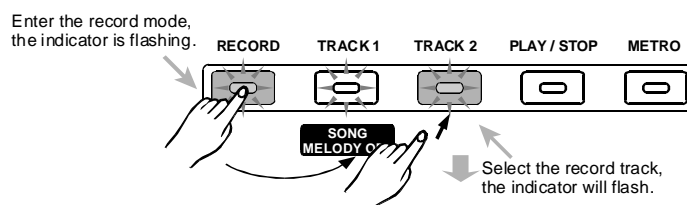

Four beats flashes synchronously to indicate waiting for recording.

#### 2、Start recording:

- When 4 beats flashes, you can play the keyboard directly to start recording, the RECORD indicator and the track flag that you select both flashes.
- When 4 beats flashes, you can also press the **[START/ STOP]** button, open the A.B.C. and start record. Press the key in the left area and sync start style, then style data are recorded to the correspond track.
- If the two tracks all have style data, it will be overwritten by the new data.

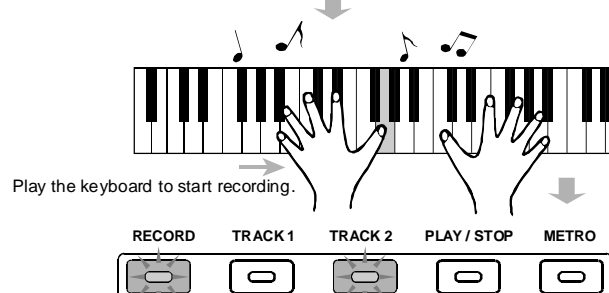

Play the keyboard to start recording.

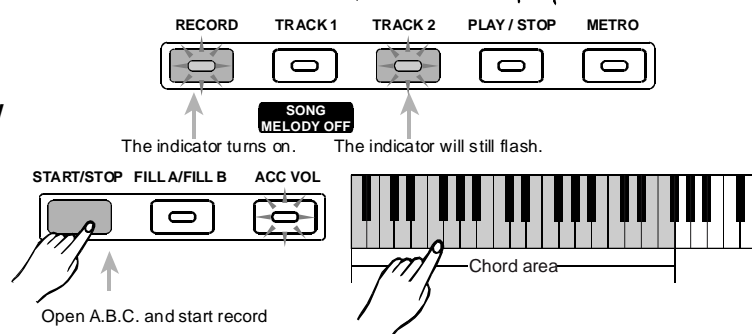

#### NOTE:

when entering record mode, the old data of the selected track will lost.

#### 3、Stop recording:

- Press the **[RECORD]** button for the second time to stop recording. LED display and indicator get back to the previous mode.
- If the capacity is full while recording, the recording will be stopped automatically with the FUL display on LED.

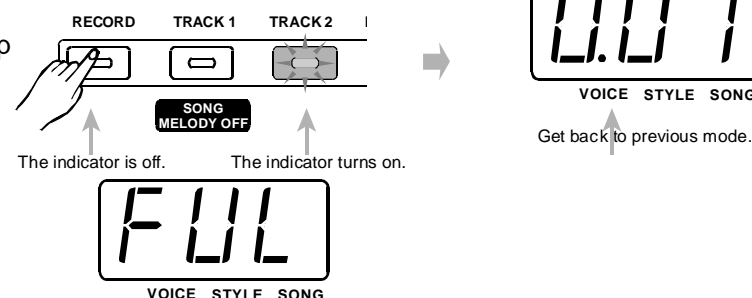

## PLAYBACK SONG

1. Press the **[PLAY/STOP]** button for the first time to playback the record data, you can choose any one track or all two tracks to play, the indicator is on.

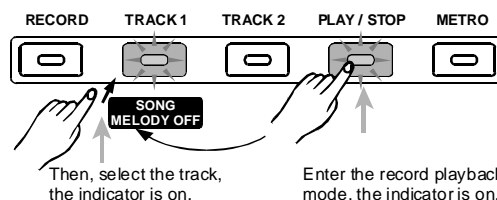

2. Press it for the second time or press the **[START/STOP]** to stop playback.

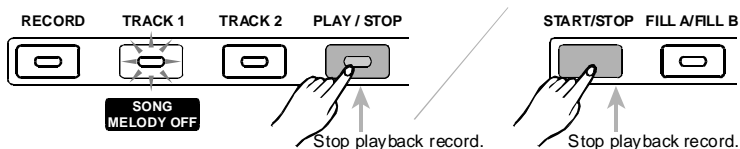

3. You can press the **[TRACK 1/SONG MELODY OFF]** and **[TRACK 2]** button to turn on or off the relative track in process of playback.

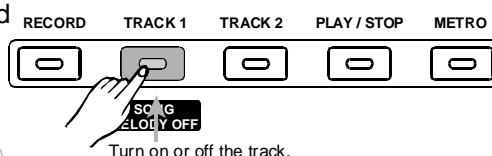

### NOTE:

If there is no record data when you press **[PLAY/STOP]**, LED will display 'NUL' temporarily.

Press **[+]** and **[-]** together when power is on and the song data will be cleared.

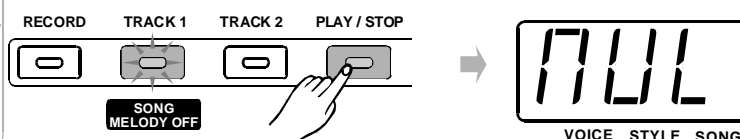

## Lesson

1. In song mode, press the **[TRACK1/SONG MELODY OFF]** button to enter the lesson mode.

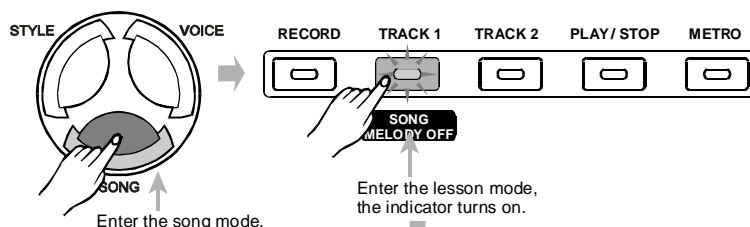

2. When you press the **[TRACK1/SONG MELODY OFF]** button, the **[TRACK1/SONG MELODY OFF]** indicator turns on, it will mute the melody of the song, then you can play the keyboard to practise the song you want.

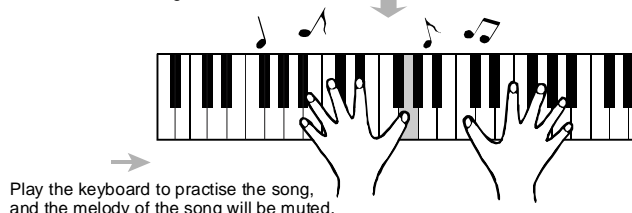

3. Press **[TRACK1/SONG MELODY OFF]** again, the indicator again goes off and melody will sound.

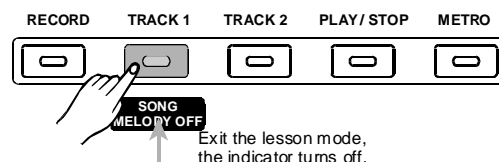

## SD Function

There is a standard SD external interface which supports the cards of 16M ~ 2G capacity. It is compatible with the file system format of the FAT 16/32.

Press one of the 2 SD buttons **[PLAY/STOP]**, **[STORE]** to enter the relative function mode.

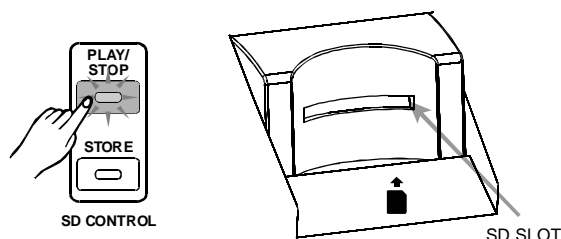

If there is no card, ERR will display two seconds.



## 1. SD card function

- **PLAY/STOP** can play/stop midi file at the root directory in SD, support format 0 and format 1.
- **STORE** can save the recorded data to SD root directory as midi file which can be played on MIDI player.

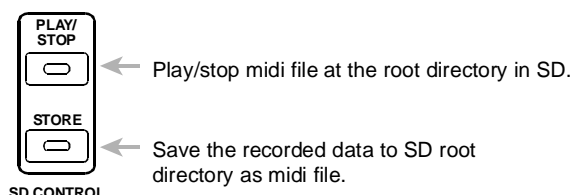

## 2. SD button

In the SD mode, it won't respond to the other button except **[VOICE]**, **[STYLE]**, **[SONG]**.

It can play MIDI file and save recorded data at the root directory.

### • Play

When power is on, press the **[PLAY/STOP]** button to play all files at the root directory in SD card and the PLAY/STOP indicator is on.

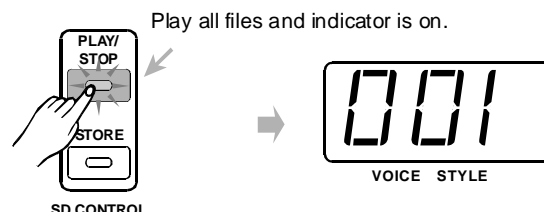

In the SD mode, you can select the midi file with **[+/YES]** or **[-/NO]** button. The default file number is 001.



When playing the midi file, you can press the **[PLAY/STOP]** or the **[START/STOP]** button to stop playing.

Press the **[START/STOP]** button again to start to play it repeatedly.

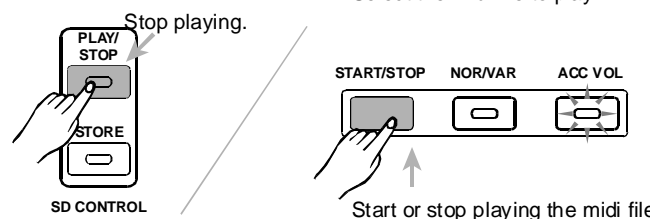

Press the **[PLAY/STOP]** button when there is no midi file in the SD card, LED display 'noF', then the display will get back to previous mode in 2 seconds.

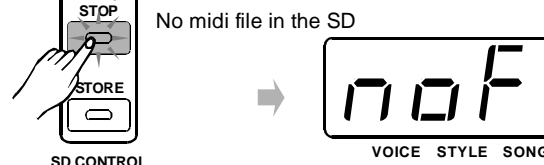

### • Store

When power is on, press the **[STORE]** button to enter store mode and the STORE indicator is on.

It can save the recorded data to SD root directory as midi file, midi file name is generated by system automatically to avoid same name.

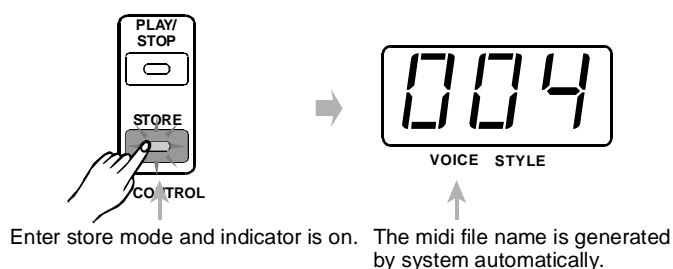

If the SD card capacity is full, it will stop saving automatically, and display 'FUL' Then exit the store mode and return to the previous mode.

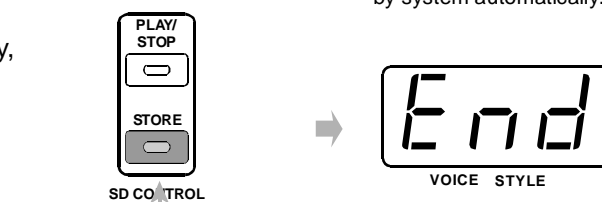

After saving, the indicator of the **[STORE]** button goes off, LED will display 'End' temporarily which means saving be over and succeed.

# MIDI Function

## What is MIDI

- 1、Musical Instrument Digital Interface. The standard interface between PC and Electronic instrument.
- 2、It is equipped with standard MIDI interface, including 1 MIDI IN and 1 MIDI OUT.
- 3、Connection  
It can connect with PC or other MIDI equipment.

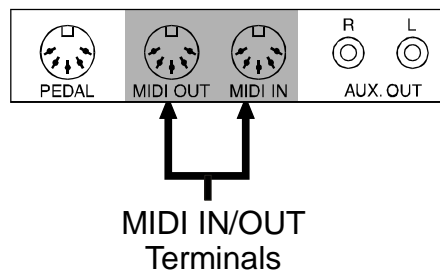

## MIDI Connection

### 1、Connection rule

In midi connection, the equipment which controls another equipment is called Host Equipment. Another equipment is called Affiliated Equipment. The host equipment's MIDI OUT connect with affiliated equipment's MIDI IN. Do not connect MIDI OUT with MIDI IN on the same equipment.

### 2、MIDI IN

You can use a MIDI cable to connect the MIDI IN terminal of system to another MIDI OUT terminal of compatible MIDI electronic instrument. Use MIDI IN, system can receive midi data such as note, program and touch etc. in order to be handled by another MIDI instrument.

### MIDI OUT

You can use a MIDI cable to connect the MIDI OUT terminal of system to another MIDI IN terminal of compatible MIDI electronic instrument. Midi data of system can be sent by MIDI OUT, when a note is generated, the relative message will be transmitted. System can control other midi instrument by sending program change messages

### 3、Sample Connection Method

Connect the MIDI interface with your PC.

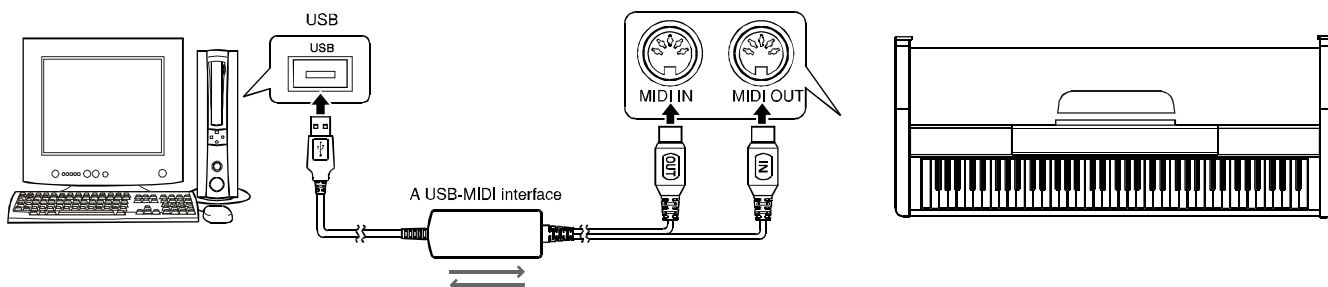

Connect the MIDI interface with other digital music instruments.

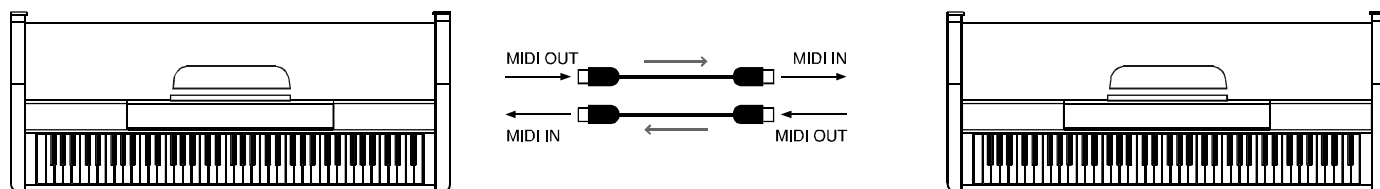

## Major Application

- 1、The piano can control other equipments or electronic instruments.
- 2、Some equipments can be used to control the piano.
- 3、PC recorded data (MIDI) can be played on the piano.

# Specifications

<b>Keyboard</b>	88 keys, 3 kinds of touch level.
<b>Voice</b>	20 voices.
<b>Style</b>	20 piano styles.
<b>Song</b>	60 songs.
<b>Display</b>	LED display.
<b>Switch and Buttons</b>	POWER SWITCH, VOLUME SWITCH, REVERB/CHORUS, DUAL, TOUCH, RECORD, TRACK 1, TRACK 2, PLAY/STOP, SPLIT, METRO, TRANSPOSE +/-, TEMPO +/-, SD CONTROL, VOICE DEMO, SONG, VOICE, STYLE, BRILLIANCE, SCALE, START/STOP, ACC VOL, FILL A/FILL B
<b>Transpose</b>	±12 semi tones
<b>Pedals</b>	Soft, Sostenuto, Sustain
<b>Connectors</b>	AC POWER, HEADPHONES, AUX.OUT, MIDI IN/OUT, USB PEDALS
<b>Speaker</b>	8ohm 25w x 2
<b>Dimension</b>	1380 x 520 x 830mm
<b>Weight</b>	62.5kg



## Voice List

No	Name of Voice	Name of Voice on Panel
001	Acoustic Grand Piano	GRD.PIANO
002	Epiano1	E.PIANO1
003	Harpsichord	HARPSICD
004	Hammond Organ	DRAWBAR
005	Accordion	ACORDION
006	Steel Guitar	ST.GUITAR
007	String	STRING
008	Trumpet	TRUMPET
009	Folk Sax	FOLK SAX
010	Jazz Flute	JZ.FLUTE
011	Bright Acoustic Piano	BRT.PIANO
012	Epiano2	E.PIANO2
013	Vibes	VIBES
014	Church Organ	CHR.ORGAN
015	Harmonica	HAMONICA
016	STR.TRIO	STR.TRIO
017	Slow String	SLOW.STR
018	Brass Section	BRASS
019	Oboe	OBOE
020	Pan Flute	PANFLUTE

## Style List

No	Name of Style
001	Pianist
002	8 Beat
003	16 Beat
004	Ballad
005	Pop Piano
006	Boogie
007	Slow Rock
008	Swing
009	Jazz
010	Jazz Waltz
011	Swing Fox
012	Shuffle
013	Twist
014	Country Ballad
015	Bossa Nova
016	Latin
017	March
018	6/8 March
019	Waltz
020	Slow Waltz

# Song List

No	Name of Song
<b>Piano</b>	
001	For Alice
002	Habanera
003	Four Little Swans
004	Moseta Dance
005	Germanic Dance
006	Turkish March
007	March
008	Away In A Manger
009	Chopsticks
010	2-Part Invention #13 In A Minor.B.W. lli
<b>Folk &amp; Country</b>	
011	Country
012	Jambalaya
013	Susanna
014	Bridge
015	Battle Hymne Of The Republic
016	The Old Gray Mare
017	American Patrol
018	In The Rain
019	Sippin`Cider Through A Straw
020	Are You Lonesome Tonight
<b>Golden &amp; Pop</b>	
021	Only You
022	End Of The World
023	House Of Rising Sun
024	The Blue-Bells Of Scotland
025	Over The Rainbow
026	Beautiful Dreamer
027	Edelweiss
028	O Sole Mio
029	Silent Night
030	Ave Maria

No	Name of Song
031	Five Hundred Miles
032	Happy New Year
033	It`S Beginning To Look A Lot Like Christmas
034	Jeanie With The Light Brown Hair
035	My Bonnie
036	Song Of The Pearlfisher
037	The Stage Coach
038	Entertainer
039	Annie Laurie
040	Killing Me Softly With His Song
041	Last Rose Of Summer
042	The Old King Cole
<b>Jazz &amp; fusion</b>	
043	Maple Leaf Rag
044	June Samba
045	Funk
046	I Can.....
047	Sea Shore
048	Guitar&Saxphone
049	The Hip Hop's Night
050	Blue Lunch
051	Cobweb
052	Wine
053	Jazz Old Man
054	Dark Eyes
055	Carlos
056	Sad
057	The Jazz
<b>Chinese</b>	
058	South Mud Bay
059	Give You A Rose
060	Flowing Rill

# MIDI Implementation Chart

Function		Transmitted	Recognized	Remarks
Basic Channel	Default	1ch	1-16ch	
	Changed	1-16ch	1-16ch	
Mode	Default		3	
	Messages Altered	*****		
Note Number :	True voice	09-120 *****	0-127 0-127	
	Velocity :			
After Touch	key s			
	Ch s			
Pitch Bend				
Control Change	0			Bank Select
	1			Modulation
	5			Portamento Time
	6			Data Entry
	7			Volume
	10			Pan
	11			Expression
	64			Sustain Pedal
	65			Portamento ON/OFF
	66	○		Sostenuto Pedal
	67			Soft Pedal
	80			Reverb Program
	81			Chorus Program
	91			Reverb Level
	93			Chorus Level
	120			All Sound Off
	121			Reset All Controllers
	123	○		All Notes Off
Program Change :				
true #		*****	0-127	
System Exclusive				
System Common	Song Position			
	Song Select : Tune			
System Real Time	: Clock			
	: Commands			
		*1	*1	
Aux :LOCAL ON/OFF				

Mode 1: OMNI ON , POLY  
Mode 3: OMNI OFF , POLY

Mode 2: OMNI ON , MONO  
Mode 4: OMNI OFF , MONO

○ : YES  
× : NO

