

- 1 Open the box and take out the U bend and the other four pipes. Loosen the four clamps on the bend and insert the two long pipes into the center two holes. Then, insert the two short pipes into the holes on either end.

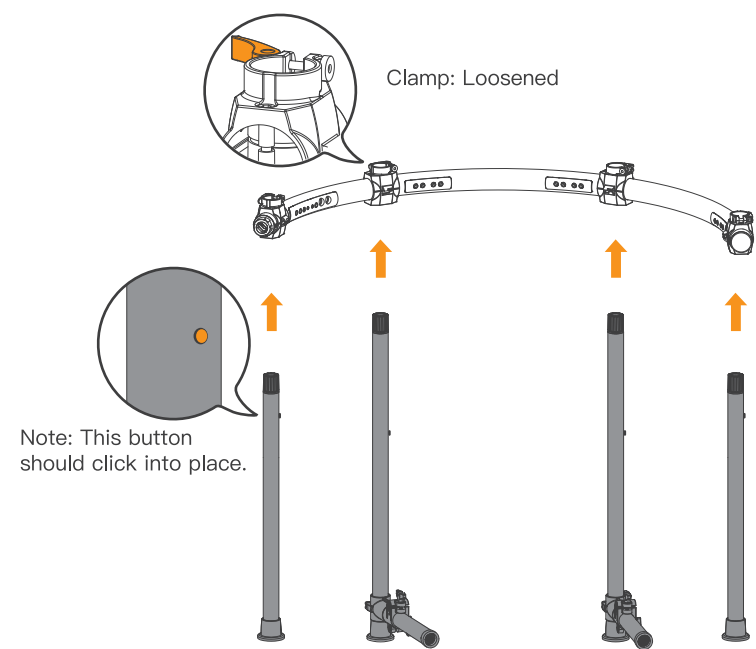

- 2 Put the drum clamps onto the two long pipes, and tighten the wing nuts.

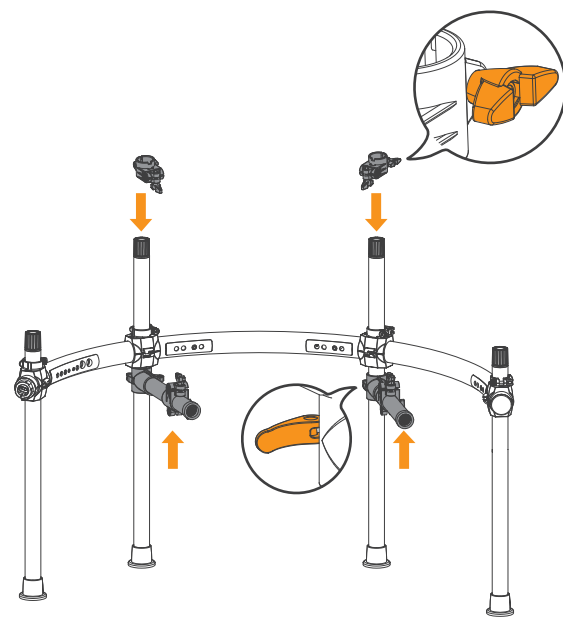

- 3 Put the smart holder onto the left long pipe, and tighten the wing nut.

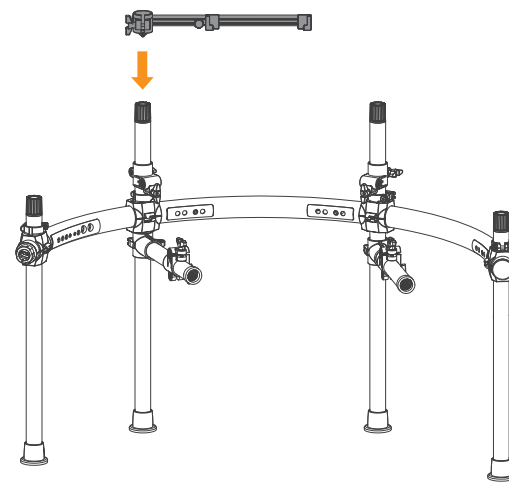

- 4 Loosen the turncap. Insert the cymbal arm into this cap as shown below, and then tighten the turncap.

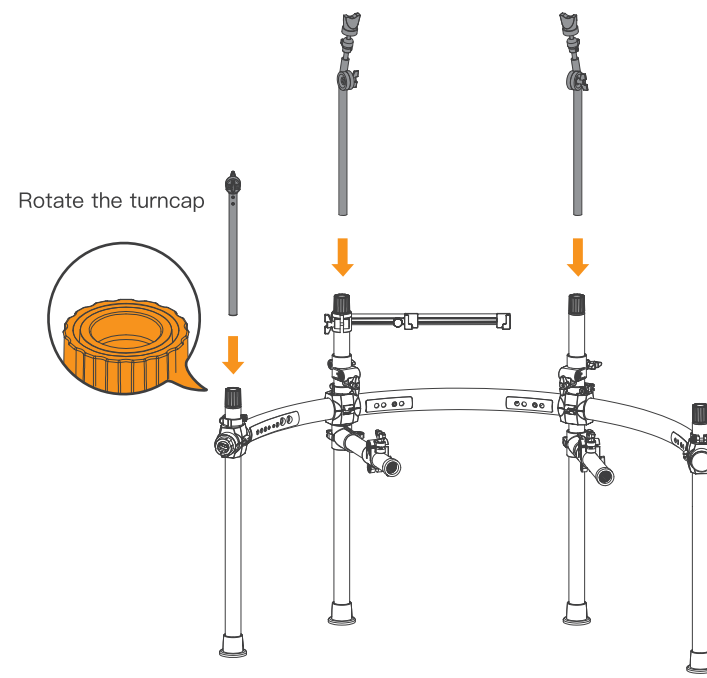

- 5 Install the L shaped HI-HAT rod and drum pad rod as shown below.

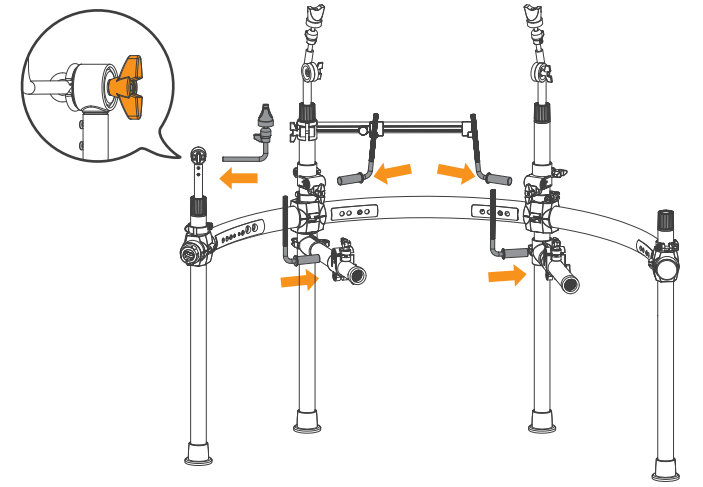

- 1 Open the box, and take out the U bend and the other four pipes. Put the tom clamp onto the right stand pipe as shown below. Loosen the four clamps on the bend and insert the two long pipes into the center two holes. Then, insert the two short pipes into the holes on either end.

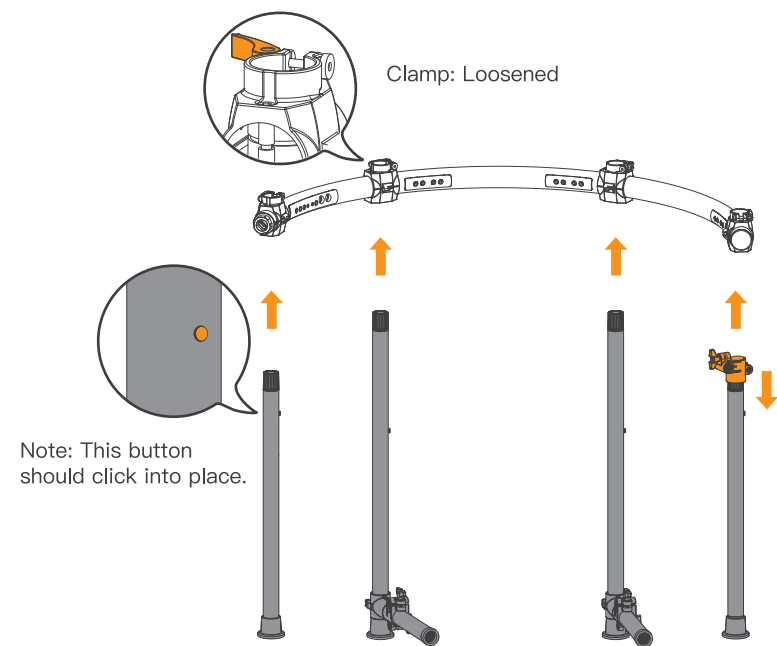

- 2 Put the drum clamps onto the two long pipes, and tighten the wing nuts.

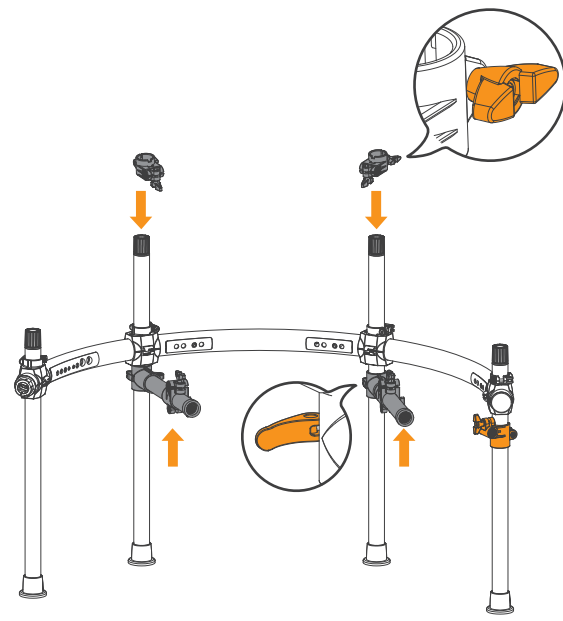

- 3 Put the smart holder onto the left long pipe, and tighten the wing nut.

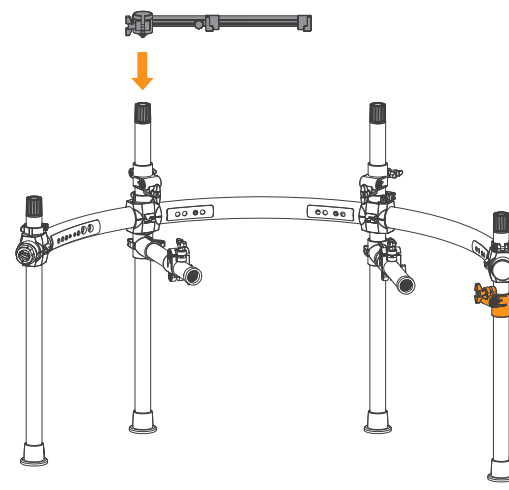

- 4 Loosen the turncap. Insert the cymbal arm into this cap as shown below, and then tighten the turncap.

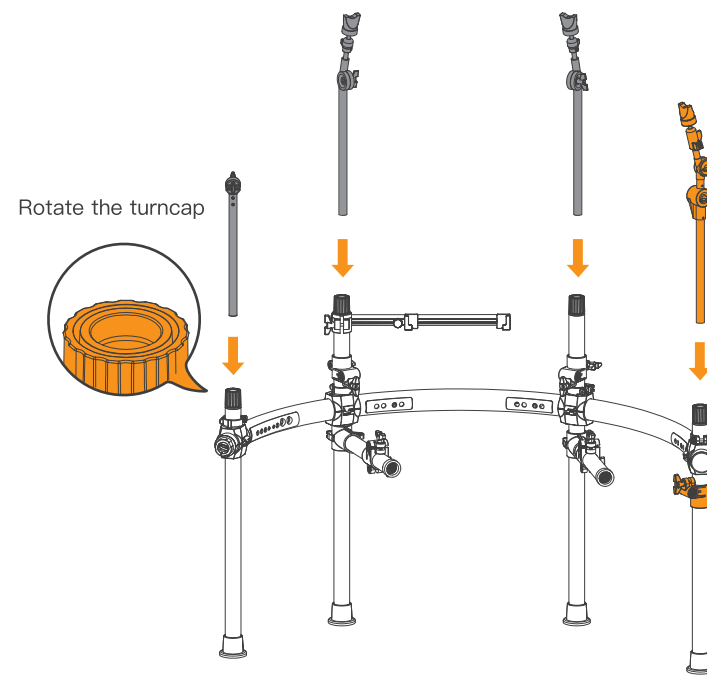

- 5 Install the L shaped HI-HAT rod and drum pad rod as shown below.

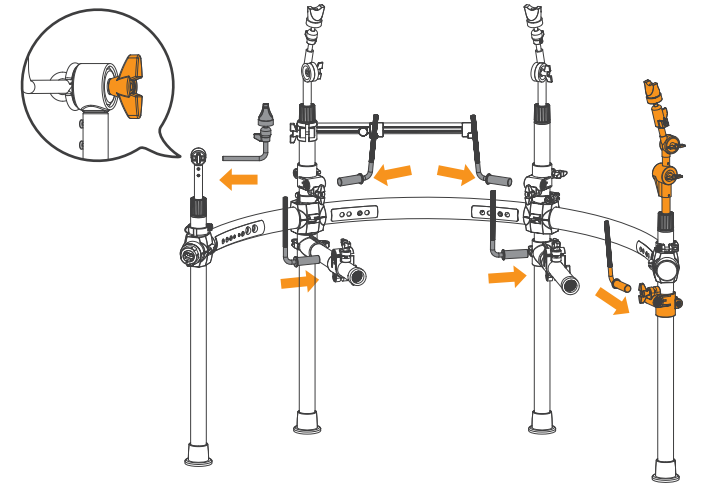

## Drum pad installation

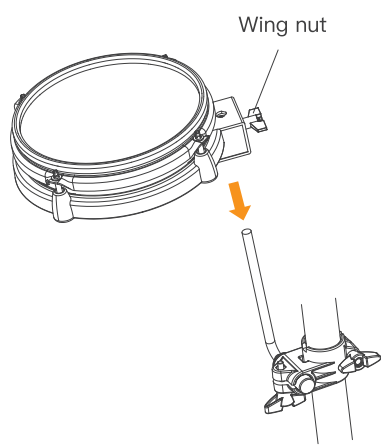

Loosen the wing nut and put the drum pad onto the L shaped pad rod. Then tighten the wing nut.

⚠ Note: We recommended installing the Snare and Tom3 first, and then Tom1 and Tom2.

## Cymbal installation

1. Loosen and remove the cymbal knob, and put the cymbal onto the cymbal arm.
2. Adjust the wing nut, and install the cymbal as shown below.

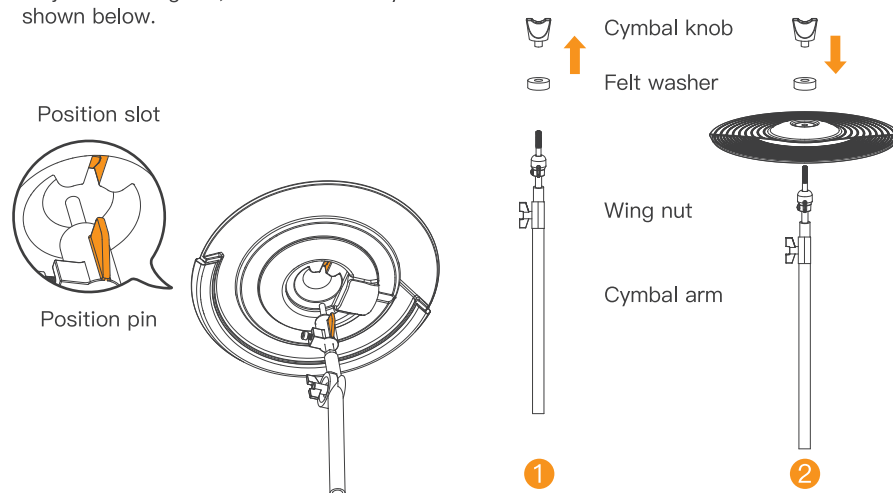

⚠ Note: The cymbal position pin should line up to fit into the position slot.

1. Loosen the square screw with the included drum key. Adjust the kick mallet to a suitable height, and re-tighten the square screw.
2. Loosen the kick pedal wing nut and latch the kick pedal to the kick drum. Then, re-tighten the kick pedal wing nut.

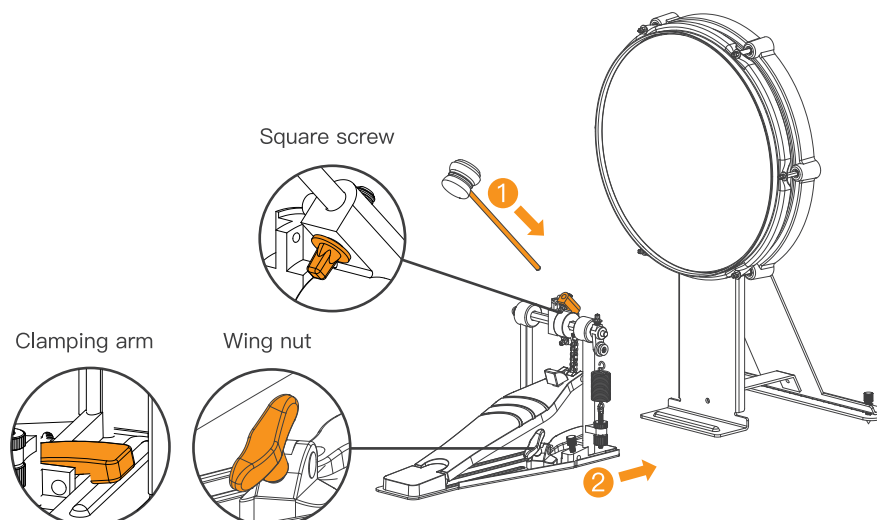

- 1 Align the slot on the module end with the joint line on the U bend and insert the module.

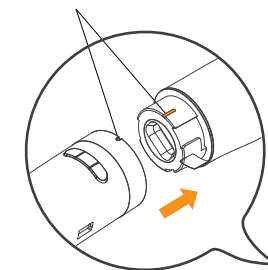

- 2 Turn the module to the right until it clicks into place.

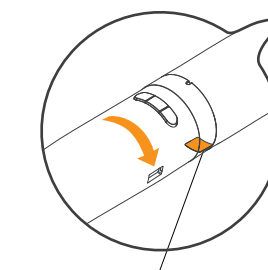

⚠ Note: To remove the drum module, press the button on the underside of the module, turn the module left, and gently pull it out.

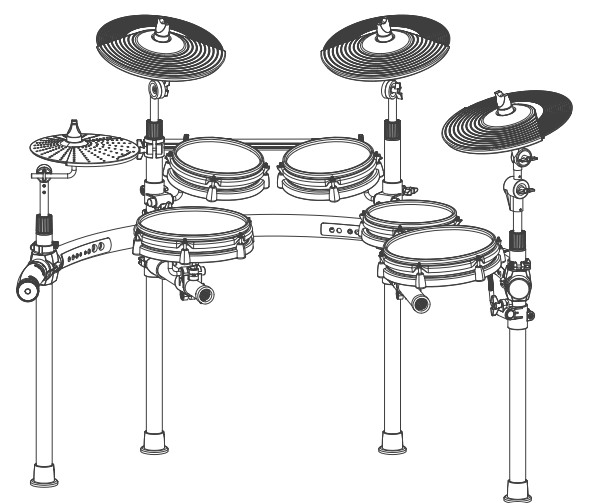

⚠ Note: CRASH2 and TOM4 are only included in G1 Pro.